

User Manual Book

Wall Chimney Hood

Imola Seri
CX 7310 L

Diva Seri
CX 9330, CX 6330, CX 9177
CX 9157

Ferrara Seri
CX 9301, CX 6301

Cesena
CX 9156, CX 9106

Modica Seri
CX 7712 L,

Forli Seri
CX 9777, CX 9753, CX 9701 L

Faenza Seri
CX 9356

Piazza Seri
CX 9150, CX 6150, CX 7110 L

MODENA

Thank you for your trust in choosing MODENA products for your household needs. With your satisfaction as our priority, we constantly aim to deliver stylishly designed products equipped with state-of-the-art technology to assist you in your daily activities.

This is your guidebook containing everything you need to know about our product. Please reach out to us if you need further assistance or other information via our Customer Care or our official website www.modena.com.

CONTENTS		PAGE
Introduction		
- Part 1	: Safety Warnings	5
- Part 2	: Name of Parts	6
- Part 3	: Installation	8
- Part 4	: How to Use	18
- Part 5	: Maintenance	23
- Part 6	: Problems & Solutions	25
- Part 7	: Precautions	25
- Part 8	: Specification	26

Part 1: Important Safety Information

- Do not allow children to operate the unit.
- This exhaust hood is designed for home use only, not suitable for the environmental condition, bake shop, barbecue, and other commercial purposes.
- The exhaust hood should be cleaned periodically so that its power is maintained.
- Clean the exhaust hood according to the instructions contained in this book and keeps it away from the danger of being burnt.
- No direct grilling on a gas stove.
- Keep your kitchen remains good circulation.
- Before connecting the unit to a power source, make sure the power cord is in good shape. If there is damage to the power cord, the replacement must be performed by qualified personnel or contact the MODENA Service Center for replacement process.
- The room should have good ventilation during the use of exhaust hood on gas stoves or other fuels.
- The exhaust hood waste pipe should be separated with an air-duct.
- Regulations regarding the air exhaust must be met.
- The unit is not intended to be used by persons (including children) with a physical, sensory, or mental disability, or lack of experience and knowledge unless they have been given supervision or instructions concerning the use of the appliance by the person who is responsible for their safety.
- Children should be supervised to ensure that they are not playing with the unit.
- Do not strike a fire under the sucker of the exhaust hood.
- The exhaust hood is not aimed to be installed on top of the stove that had more than four burners.

Electrical Shock Hazards

- Connect the unit only to a grounded power socket correctly. If you are in doubt, ask advice from an experienced technician who is suitably qualified.
- The failure to follow these instructions may cause electric shock, fire, or other hazards that are fatal.

Part 2: Name of Parts

CX 9150, CX 9330, CX 9753, CX 7110 L, CX 7310 L, CX 9156, CX 9301, CX 9356, and CX 9701

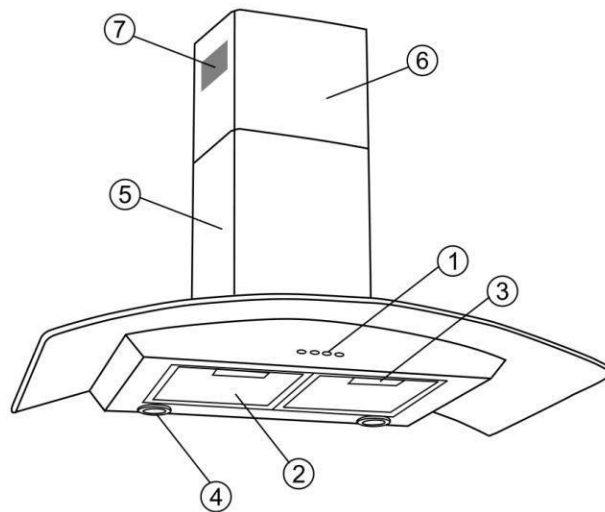

** The image is a general overview and is not necessarily the same as the product you receive.
* Features and other attributes are depending on the type of products*

1. Control Panel
2. Cassette Aluminum Filter
3. Cassette Aluminum Filter Handle
4. Lamp
5. Main Chimney
6. Upper Connector Chimney
7. Circulation Hole

CX 7712

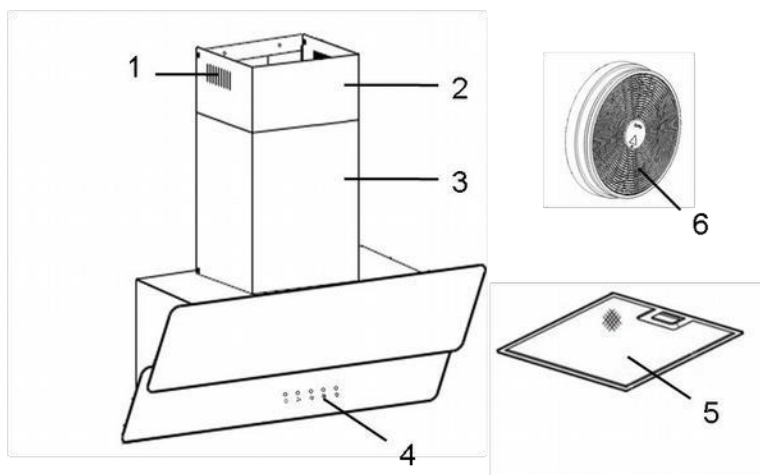

** The image is a general overview and is not necessarily the same as the product you receive.
* Features and other attributes are depending on the type of products*

1. Circulation Hole
2. Upper Chimney
3. Main Chimney
4. Control Panel
5. Aluminum Filter
6. Carbon filter

CX 9777

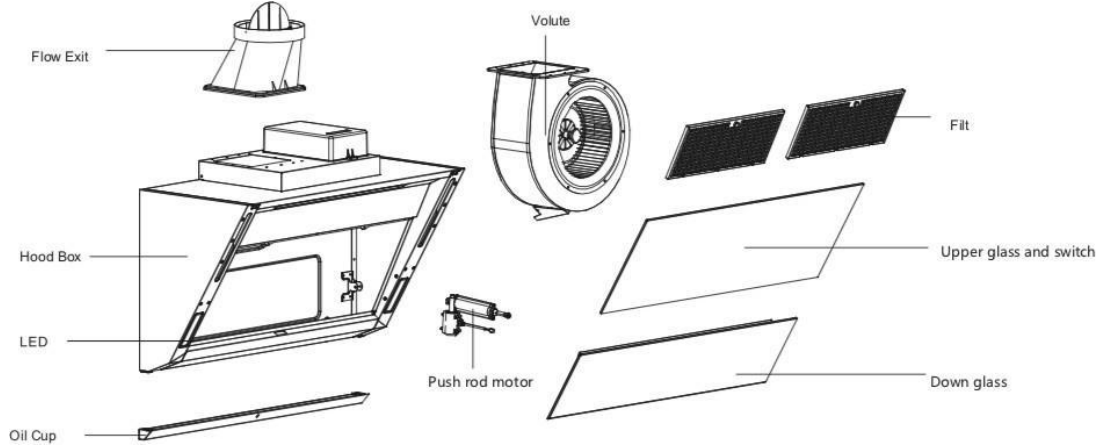

* The image is a general overview and is not necessarily the same as the product you receive.
 * Features and other attributes are depending on the type of products

CX 9157/ CX 9177

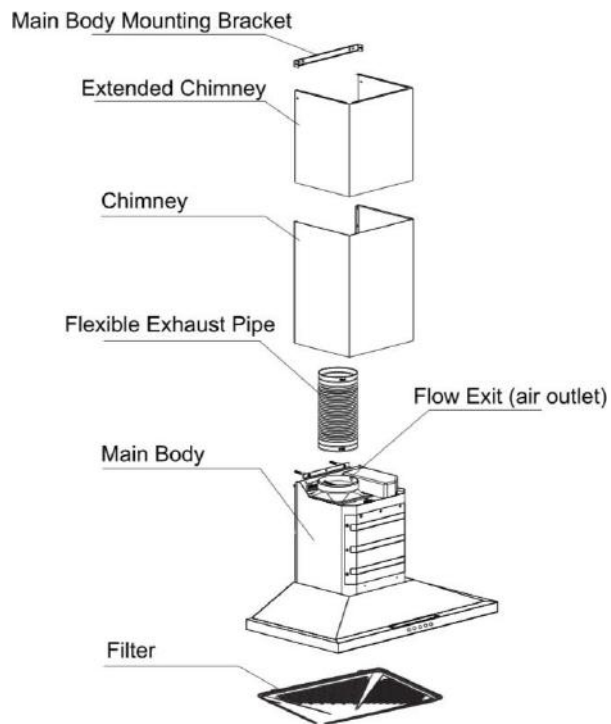

* The image is a general overview and is not necessarily the same as the product you receive.
 * Features and other attributes are depending on the type of products

Part 3: Installation

CX 9150, CX 9330, and CX 9753

Preparations of installation:

The exhaust hood is equipment which vacuums the smoke and odor produced in cooking process. With an exhaust hood, your kitchen will be free from oil particles which produces bad odor.

1. Check the strength of wall on which the hood is to be installed. Make sure the wall can sustain the weight / load of the hood.
2. The hood should be installed precisely over the stove at a vertical distance of 65 - 75 cm from the stove surface.

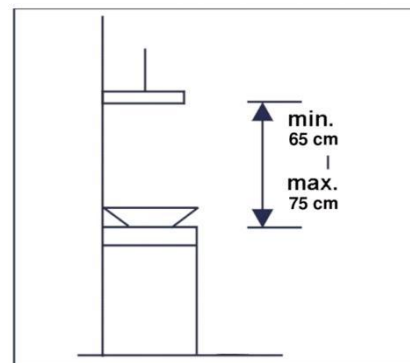

INSTALLING THE HOOD ON WALL

The hood must be installed in an upright position to prevent the oil from flowing to one side and dripping out of the exhaust hood.

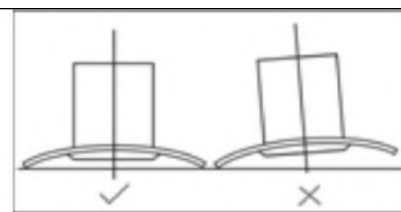

Creating holes on the wall and methods for installing bracket

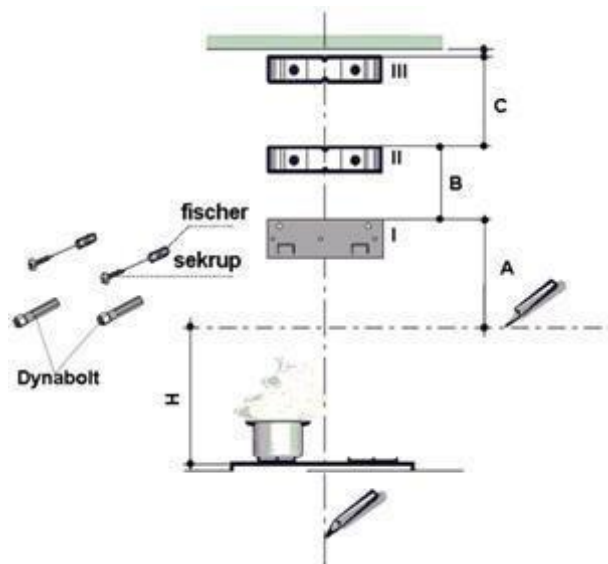

Model	A (cm)	B (cm)	C (cm)
CX 9753	37.5	39	39
CX 9330	34.5	20.5	49
CX 6330	34.5	20.5	49
CX 9150	34.5	20.5	49
CX 6150	34.5	20.5	49

Notes:

- Height / distance are 65 – 75 cm, except for CX 9753 type where the height / distance is 35 – 40 cm.
- For CX 9753, we recommend installation for use with a stove without the top cover.
- Height / Distance C can be shortened in accordance to the ceiling height.
- Make a vertical line on the wall to its highest point or to an appropriate height on the center part of the area where the vent hood is to be installed

- Make a horizontal line at H (cm) distance from the stove to mark the lowest limit for the hood.
- Install bracket I on the wall just like on the picture above up to height A and mark the holes for dynabolt and fischer. Especially for CX 9753, attach the unit on the wall up to height A and mark the holes for dynabolt/fischer/screw.
- Install bracket II on the wall just like on the picture above up to height B and mark the holes for fischer hole.
- Install bracket III on the wall just like on the picture above up to height C and mark the holes for fischer hole.
- Drill the wall with a \varnothing 10 mm for dynabolt and \varnothing 8 mm for fischer in all marked sections.
- Insert the dynabolt and fishcer into the hole.
- Install all brackets using nut for dynabolt and screw for the available fishcer

Installing the Hood Body

- Install hood's body on the bracket I on the wall, or on the screw head especially for CX 9753.
- Connect the exhaust system with the spigot / flange if the exhaust hood will be operated in a ducting / exhaust system.
- Install the main chimney and the upper chimney on brackets I and II with the screws that already provided.

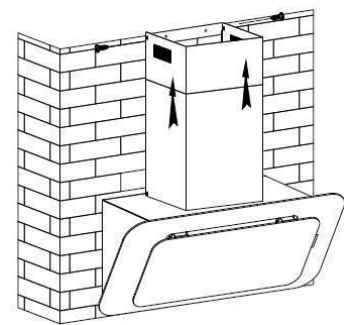
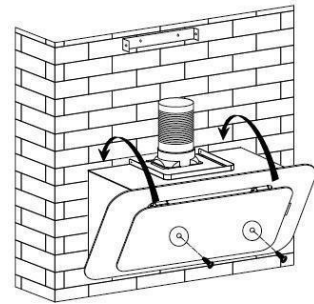

WORK METHOD

MODENA exhaust hood has 2 principle of work:

DUCTING SYSTEM:

In this mode, the hood operates by sucking the smoke / odor in the cooking process and then releasing it out of the vent through the exhaust system.

To connect the hood with the duct system, use "spigot/flange" which are designed with a diameter of 150 mm.

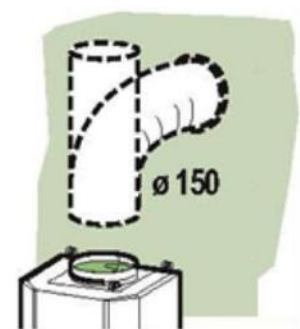

Several things which require attention in installing the ducting system exhaust hood:

1. Carbon filter must be removed. Only use the aluminum filter.
2. If the hood is installed in a multi-storied building or an apartment, consult with the person in charge of the building / apartment prior to installing the exhaust system.
3. Hood with ducting system should be used in an open-air room with good air circulation.

RECIRCULATING System

In this version, the vent hood sucks the smoke / cooking odor and filters it through an aluminum filter and carbon filter. The filtered smoke is then reticulated into the room. This system is used if the premise renders it impossible to install a ducting system

Several things which must be ensured when installing a vent hood with reticulating system:

1. Both carbon filter and aluminum filter must be used.
2. The position of both filters must be precise.
3. Circulation holes on the exhaust hood are not allowed to be closed

CX 7110 L, CX 7310 L, CX 9156, CX 9301, CX 9356, and CX 9701

Preparations of installation:

- If you have a waste pipe outside, the exhaust hood can be connected using extraction duct (enamel, aluminum, flexible pipe or a fire-resistant material with an inner diameter of 150 mm), see the following picture:

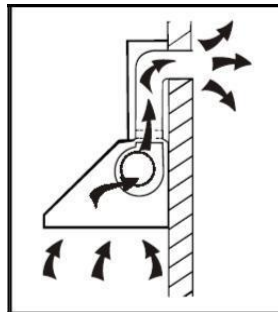

- Before installation, switch off the unit and unplug the power cord from the power socket

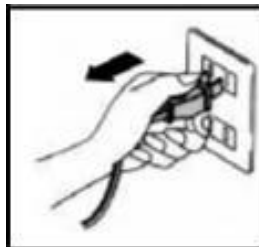

- Installation of the exhaust hood should be right on the top of the stove with a minimum distance of 65 cm and a height of maximum 75 cm from the surface of the stove

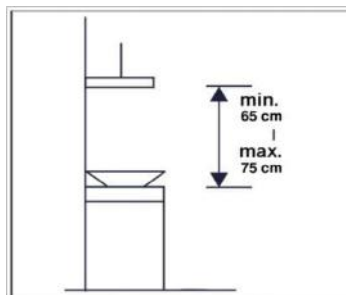

- **Installation (DUCTING / EXHAUST System):**
Attention! Observe the warning in the instruction sheet concerning the operation of the appliance when air is discharged from the room

When the range hood and appliance supplied with energy other than electricity are simultaneously in operation, the negative pressure in the room must not exceed 4 Pa (4×10^{-5} Bar)

- Drill 3 x 8mm holes to accommodate the bracket. Screw and tighten the bracket onto the wall with the screws & screw plugs provided

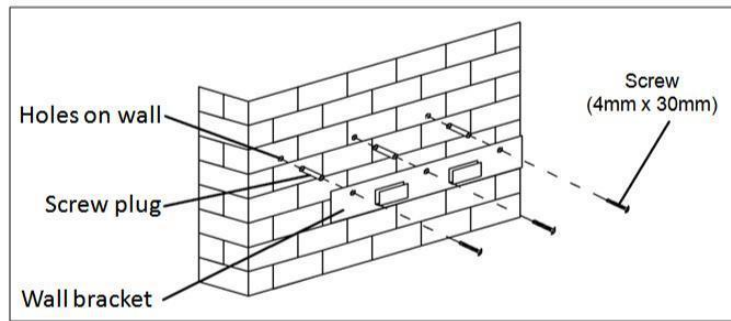

- For inclined panel Model, need to drill 4 x 8mm extra holes & fixing screws & screw plugs before installation.

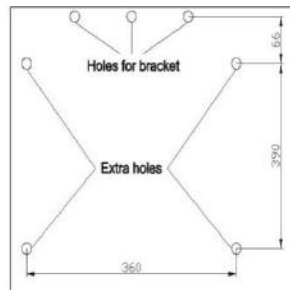

- Leave up the exhaust hood and hang onto the wall bracket hook.

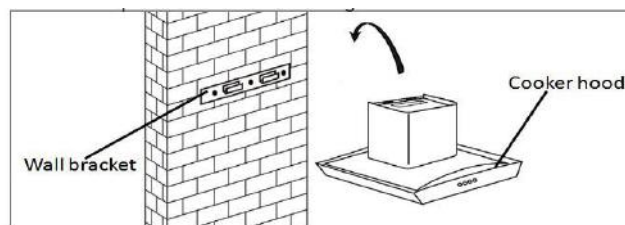

- Fix the one-way-valve to the air outlet of the exhaust hood. Then, attached the exhaust pipe into the one-way-valve as shown below.

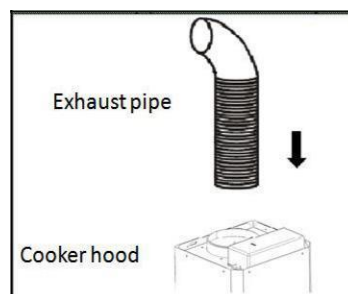

Chimney installation For Glass model and T shape model

- By put the upper chimney into lower chimney. Then pulling out the upper chimney upwards. Adjust to reach the height required.

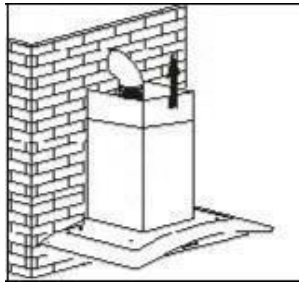

- Sliding the chimney to adjust the chimney height. When the height you required is reached, then hang the fixing hole to the fixing screws as showed in below pictures

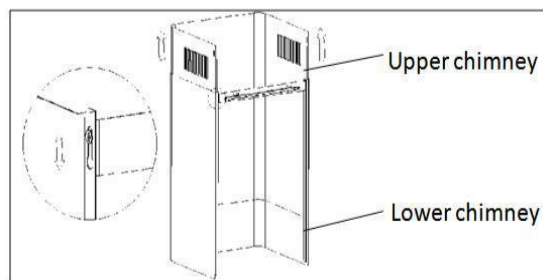

- Drill 2 x 8 mm holes to accommodate the plate II. Screw and tighten the plate II into the wall with two screws provided. Assembly the chimney into the unit and fix it with two screws

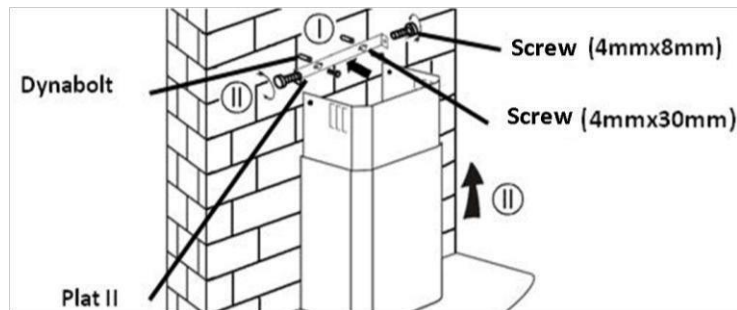

For Tower model

- Put the inner chimney into upper chimney. Then pulling out the upper chimney upwards. Adjust to reach the height required

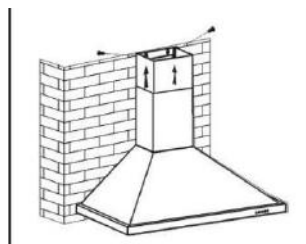

- Fix the lower chimney with two pieces of 4x8 mm screws

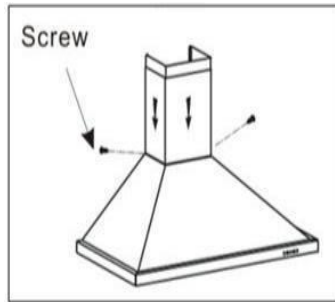

- Sliding the chimney to adjust the chimney height. When the height you required is reached, then fix two pieces of 4x8 mm screws onto the hole fixing with plate I as showed in below pictures

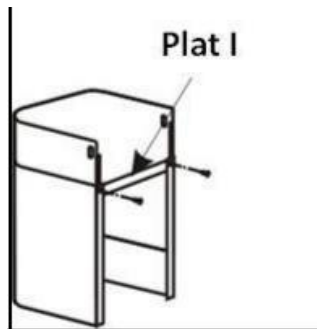

- Drill 2 x 8 mm holes to accommodate the plate II. Screw and tighten the plate II into the wall with two screws provided.
- Assembly the chimney into the unit and fix it with two screws.

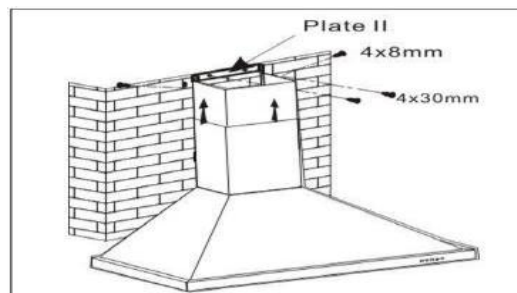

Installation (Re-circulating System):

- If you do not have an outlet to the outside, exhaust pipe is not required and the installation is similar to the one show in section "Installation (DUCTING / EXHAUST System)".

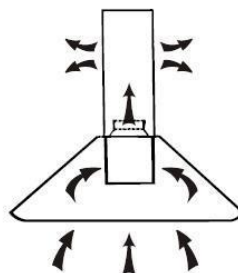

- Activated carbon filter can be used to trap odors.
- In order to install the activated carbon filter, the grease filter should be detached first by press the lock and pull it downward.

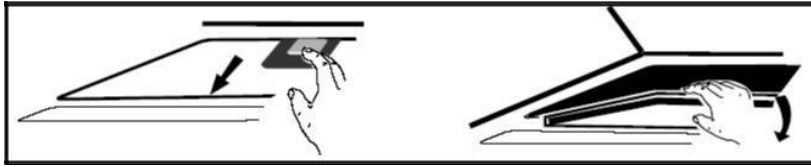

- Plug the activated carbon filter into the unit and turn it in clockwise direction. Repeat the same on the other side

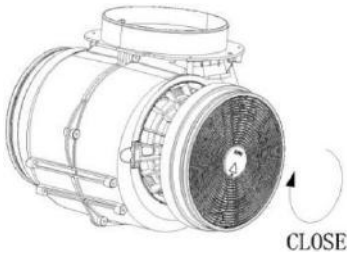

Note:

- Make sure the filter is securely locked. Otherwise, it would loosen and cause dangerous.
- When activated carbon filter attached, the suction power will be lower.
- Carbon filters are installed at the rear of the grill and had to be replaced after three months.

Warning:

Carbon filters cannot be wash or recycle. Maximum use of carbon filter is 120 hours of use and must be replaced afterwards. Carbon filters should not be exposed to heat

CX 9157, CX 9177, CX 9777

IMPORTANT: Installation must be carried out by our registered contractors

Installation Height

Minimum height from the hob surface to the underside of range hood:

- 300 mm for electric hob
- 350 mm for gas hob

*If the instruction for the gas hob installation specified a greater distance, this has to be taken into account

NOTE: Any installation above 700mm will compromise the performance of this range hood. The total height of the hood is 660 mm. In order to disassemble the protective cover smoothly, the distance between the top end of the hood and the ceiling is at least 20 cm, and the distance between the two sides of the hood and the kitchen cabinet is 10 mm.

NOTE: Any installation above 700mm will compromise the performance of this range hood. The total height of the hood is 660 mm. In order to disassemble the protective cover smoothly, the distance between the top end of the hood and the ceiling is at least 20 cm, and the distance between the two sides of the hood and the kitchen cabinet is 10 mm.

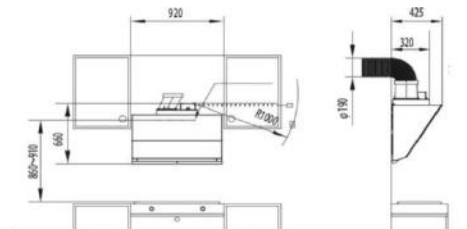

If the ceiling is low and hood is installed without extended chimney, there should be at least 3cm gap between the ceiling and chimney

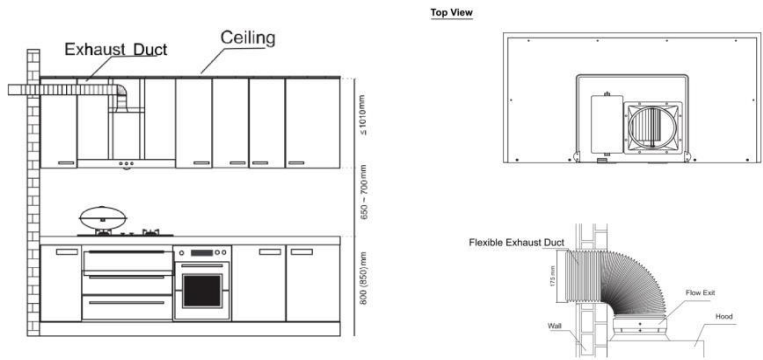

- Any distance above 700 mm will affect the performance of this range hood.
- Do not connect the range hood exhaust to the same conductor used to circulate hot air or for evacuating fumes from other appliances generated by other than an electrical source.
- If the hood is installed under a low ceiling without the extended chimney, there should be a minimum of 30 mm gap between the ceiling and the main chimney. In order to obtain optimal air extraction:
- Keep exhaust duct short and straight.
- Do not reduce the size or restrict the exhaust duct.
- Minimize bends.
- Make sure the helix of the flexible exhaust duct is tightly drawn rather than slacking.

1. Determine height between cooker hob and base of hood.
2. Mark wall to suit all bracket locations. Drill holes of 50 mm depth at the selected drilling position.
3. Insert the expansion tubes to fix the bracket onto the wall.
4. Install the flow exit to the hood and follow by connecting the flexible exhaust duct to the flow exit.
5. Strengthened the connection between the flow exit and the flexible exhaust duct with screws.
6. Lift and hang the hood to the wall bracket and please ensure it sits firmly on the bracket.
7. Direct the other end of the flexible exhaust duct to the outlet or wall.
8. Fit in the safety baffle of the hood onto the wall to strengthen the position and to reduce vibration when the hood is switched on.
9. Chimney extension can be installed to the ceiling or wall.
10. Ensure the oil collection container is in place before the hood is being used. To remove it for cleaning, slide the oil collection container from front to rear, vice versa for inserting it into position

1. Ensure there is proper ventilation in the cooking area.
2. Instructions concerning the discharge of air have to be followed.
3. Does not use flame under the range hood.
4. Avoid using materials which could cause spurts of flame near the range hood.
5. Never touch the lamp when it is on.
6. Do not dismantle, repair or modify the range hood on your own.

CX 7712 L

Preparations of installation:

Exhaust hood is equipment which sucks smoke and cooking fragrance. With a vent hood, your kitchen will be free from oil particles that may produce bad odor

1. Check the strength of wall on which the exhaust hood is to be installed. Make sure the wall can sustain the weight/ load of the vent hood.
2. The exhaust hood should be installed precisely over the stove at a vertical distance of 65 - 75 cm from the stove surface. Especially for incline/angle type the vertical distance is 35 – 45 cm.

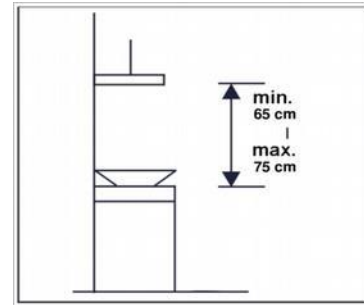

Installing the Cook Hood on The Wall

Exhaust hood must be installed perpendicularly to prevent the oil from flowing to one side and dripping out of the vent hood.

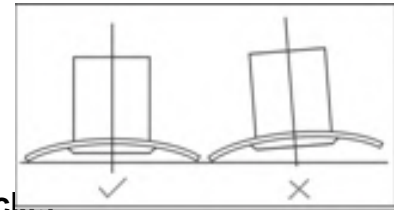

Creating holes on the wall and methods for installing brackets.

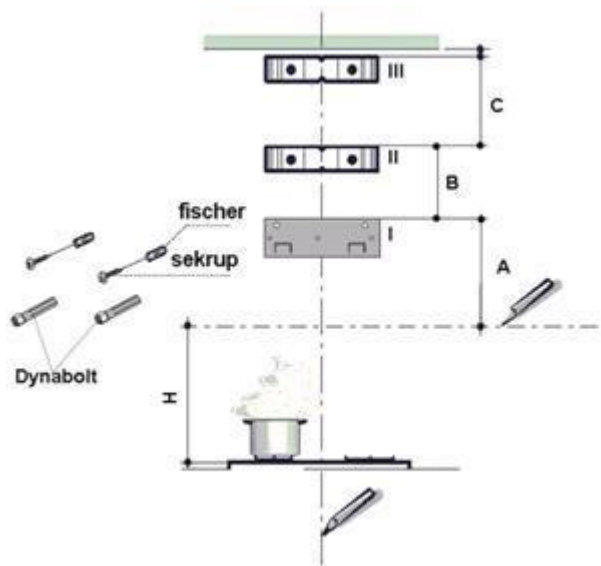

Model	A (cm)	B (cm)	C (cm)
CX 7712 L	25	39	39

Notes:

- Height / distance are 35 - 45 cm.
- For CX 7712 L, we recommend installation for use with a stove without top cover.
- Height / Distance C can be shortened in accordance with the ceiling height.
- Make a vertical line on the wall to its highest point or to an appropriate height on the center part of the area where the vent hood is to be installed
- Make a horizontal line at H (cm) distance from the stove to mark the lowest limit for the vent hood.
- Install bracket I on the wall just like in the above picture up to height A and mark the holes for fisher.
- Install bracket II on the wall just like in the above picture up to height B and mark the holes for fisher hole.
- Install bracket III on the wall just like in the above picture up to height C and mark the holes for fisher hole.
- Drill the wall with a \varnothing 8 mm for fisher in all marked sections.
- Insert the fisher into the hole.
- Install all brackets using the provided fisher screws

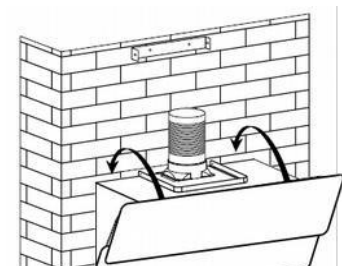

Installing the Cook Hood's Body

- Install hood on the bracket I on the wall
- Connect the exhaust system with the spigot / flange if the vent hood is to be operated as a ducting / exhaust system).
- Install the main chimney and the upper chimney on brackets I and II with the available screw.

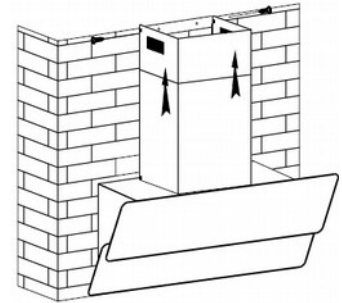

WORK METHOD

MODENA hood have 2 versions of work method, as following:

Exhaust System:

- In this mode, the hood operates by sucking the smoke / cooking odor and then discharging it out of the vent through the exhaust system.
- To connect the hood with the discharge duct, use "spigot/flange" is designed with a diameter of 150 mm.

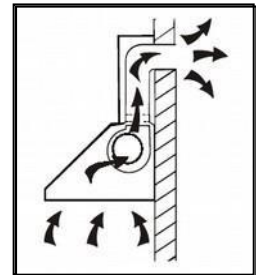

Several things which require attention in installing the ducting system vent hood:

1. Carbon filter must be removed. Only use the aluminum filter.
2. If the hood is to be installed in a multi-storied building or an apartment, consult with the person in charge of the building / apartment prior to installing the exhaust system.
3. Hood with ducting system should be used in an open-air room with good air circulation.

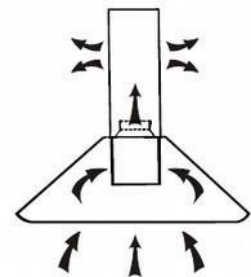

Re-circulation System

- If you do not have an outlet to the outside, exhaust pipe is not required and the installation is similar to the one show in section "Installation (Exhaust System)".
- Activated carbon filter can be used to trap odors.
In order to install the activated carbon filter, the grease filter should be detached first by press the lock and pull it downward

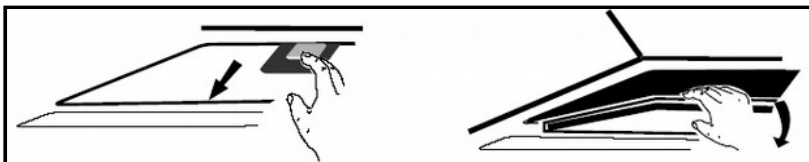

- Plug the activated carbon filter into the unit and turn it in clockwise direction. Repeat the same on the other side.

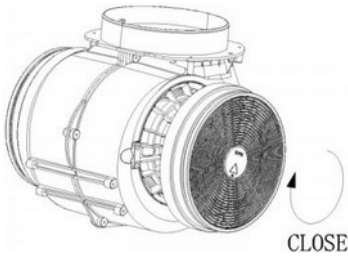

Note:

Make sure the filter is securely locked. Otherwise, it would loosen and cause dangerous. When activated carbon filter attached, the suction power will be lower. Carbon filters are installed at the rear of the grill and had to be replaced after three months.

Warning:

Carbon filters cannot be wash or recycle. Maximum use of carbon filter is 120 hours of use and must be replaced afterwards. Carbon filters should not be exposed to heat.

Part 4: How to Use

CX 9150, CX 9330, and CX 9753

Connect the power cord with a power socket.

Slide or press the motor speed button to turn the hood on or off as shown in the following image.

Notes:

Adjust the motor speed of the exhaust hood according to the thickness of smoke / steam generated in the cooking process.

PUSH BUTTON

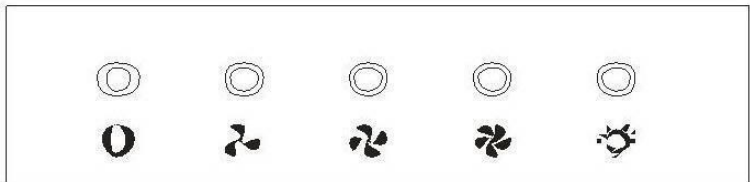

OFF / 0 To switch off the Hood



Activate Motor at Low Speed



Activate Motor at Medium Speed



Activate Motor at High Speed



To Turn On/Off the Light

Electronic Button + DISPLAY

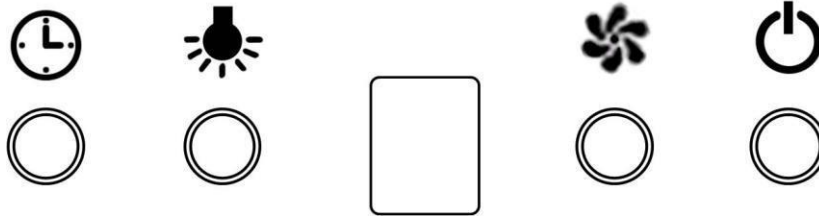

To Turn On/Off the Hood



To Adjust the Motor's Speed (Low-Medium-High)



To Activate the Shut-off Timer (After 9 Minutes motor will switch off automatically)



To Turn On/Off the Light

TOUCH BUTTON

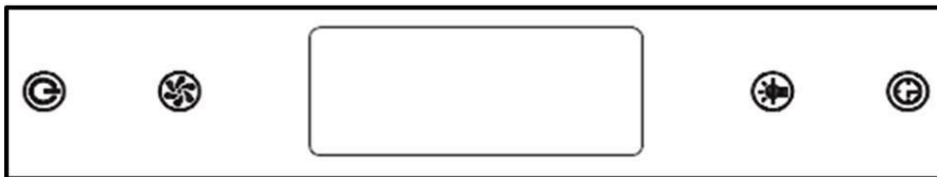

To Set the Usage Time



To Turn On/Off the Light



To Adjust the Speed Level (Low-Medium-High)















To Turn On/Off the Hood

If the button is pressed, the unit will work in which the motor speed depending on the last setting

Clock Setting



The default setting for the time when it was first turned on is 12:00 PM. If the power is not connected or cut off, the unit will return to the initial setting is 12:00 and you have to reset.

To set the clock can be done when the motor and lights are not in working condition. The way to setting the clock as follow:

1. Touch the button  around 2 until 5 seconds, the display will show  , the first two digits will blink indicates for setting of the hours. Then adjust with touch the  button to increase or the touch  to decrease. The largest value for hour is 23  and will not working if it is exceeded 23 and function  will not working if it has reached the lower limit of 00. The addition value by every touch is 01.
2. Touch the  button once more for 2 until 5 seconds, the display will show  , , the last two digits will blink which indicates to set the minute. Then adjust it by touching the button  to increase or the  button to decrease. The largest value for minute is 59  and will not working when it is exceeded 59 and function  will not working if it reached the lower limit of 00. The addition value by every touch is 01.
3. Press the  button one more time to finish the Clock's Setting

Setting the Timer

The Timer can be set when the motor or lamp is on. Timer duration is set in three periode: 5 minutes/ 15 minutes / 30 minutes/ Cancel.

1. To set the timer, touch the button  once for 5 minutes, twice for 15 minutes, thrice for 30 minutes, four times to cancel, five times for 5 minutes and so on. After the timer's time is finish, the motor and lamp will turn off automatically.
2. To change an ongoing timer, touch the button  for 5 seconds or until the correct time is displayed.

CX 7110 L, CX 7310 L, CX 9156, CX 9301, CX 9356, and CX 9701

Plug the power cord into the power socket.

Turning on or turning off the exhaust hood and exhaust hood lights can be done by sliding or pressing a motor speed regulator button and the lighting button as shown below.

Note:

The setting of the exhaust hood motor speed is adjusted to the thickness of the smoke/ steam that arises when cooking.

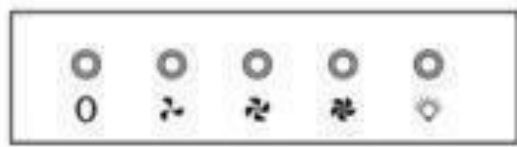

0 On / Off Buttons

The Button to Turn ON/Off the Hood

☞ Motor Speed Button - LOW

Suitable for kitchens or cooking condition that does not cause a lot of smoke or steam.

☞ Motor speed button - MEDIUM

Suitable for kitchens or cooking condition that does not cause a medium amount of smoke and steam

☞ Motor speed button – HIGH

Suitable for kitchens or cooking condition that causes a high amount of smoke and steam

☞ Buttons to turn on/ off lights

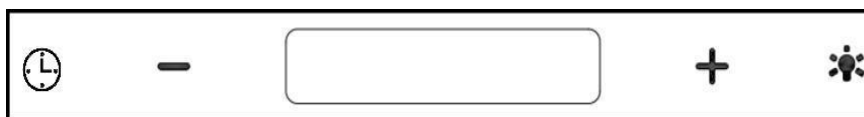

TOUCH button type / Touch control



After plug in power, it will automatically sets in standby mode

Timer's Button

Times setting keep pressing it while in standby mode to enter time setting, hour display will flash, press "+" or "-" to set the time.

Press "" to change into minute setting, press "+" or "-" to set the time, press "" again or wait 10s to finish the time setting.

Timer setting, short press during working mode, pre-set cycle: off→15mins→30mins→45mins→off: off→15menit→30menit→45menit→off.

Press " + " or " - " to adjust the time unless when the timer setting is "off"

+ **Speed increase button**

- **Speed decrease button**

 **Light button**

LCD Display

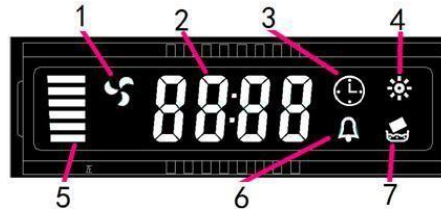

1. Fan symbol will be active when the fan is working
2. Time display
3. Timer
4. Light
5. Fan speed
6. Alarm symbol
7. Active buzzer carbon replacement symbol

CAUTION:

- Avoid a direct contact between the stove being turned on and the exhaust hood .
- To get the optimal filtering, a exhaust hood should be turned off 20-30 minutes after cooking is finished.

CX 9157, CX 9177, dan CX 9777

Operating Instructions

Confirm that when the hood is installed, plug in the power cord, and the hood sends out a "drip" sound, indicating that the power is connected.

Please use the following methods for the first time. If there is any discrepancy, please contact the local distributor or service department as soon as possible



- To start the hood, press the wake button first and then touch the ring with clockwise touch. The wind is changed from small to large, when the whole ring is red when it starts to suck, it keeps running for 3 minutes, and then automatically switches to strong gear, and the ring of the ring turns off a section, if it is to be reopened again to the whole circle.
- All the display lights up for 1 second and then goes out. The buzzer sends out a “bite” prompt, and the whole machine enters the shutdown state.
- Gesture control: When the machine is shut down, the palm swings from left to right or from right to left once, and the hood starts. The fan runs in strong gear and the lighting is turned on at the same time.
- Power key: for switch/delay operation. When shutdown operation is invalid, press this key to shut down or enter a delay of 3 minutes.
- Weak gear key: Used to set the weak gear of air volume. When the power is on, press this key shortly to switch the air flow gear between weak gear and close cycle.
- Super suction key: Used to set the air volume of super suction gear. The super-strong suction time is 3 minutes, after 3 minutes, it will automatically turn into strong-gear operation state.
- Lighting keys: used to turn on or off lights
- Cleaning Lock Screen Function: Press the Lighting keys for 3 seconds to enter the cleaning lock screen state, and press 3 seconds to exit the cleaning lock screen.
- The indicator light of “strong key” keeps flickering; the hood enters the state of cleaning lock screen. Press the “strong key” for 3 seconds to exit the lock screen. The buzzer whistles and the panel close.
- Clock display: In the state of clock display, press the power key for a long time. Start flickering in the hourly area, press the “weak” or “strong” button
- Adjust the clock. After setting the hour, press the “power” button, switch to the minute area and start flickering. Adjust the minute and press again.
- After 3 seconds, save the clock settings.

CX 9157/ CX 9177

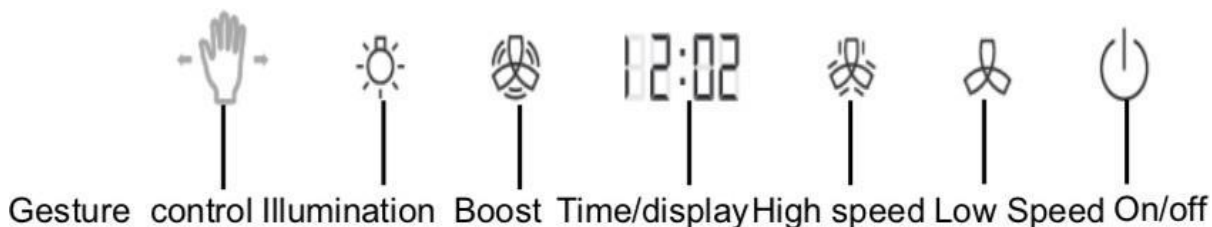

- Gesture control: When the hood is off, use your hand to wave from right to left above the icon once; the hood will start to work immediately. At the same time, the light will be turned on. When the hood is working, use your hand to wave from left to right above the icon once, the hood will stop working immediately. At the same time, the light will be turned off.
- Illumination: Touch the icon to turn on the light and touch one more time to turn off the light. Boost: Touch this icon once and the hood will start to work in the state of boost for 3 minutes and then change to work at high speed. If you want to make the hood work at boost state again, touch the icon one more time.
- Time/display: In the state of time/display, touch and hold the icon “On/off”, “hour” area will start to flash, and





you can touch “Boost” or “High speed” to adjust the “hour” digit. After the “hour” digit is set, touch the “On/off” icon, then “minute” area will start to flash and you can adjust the “minute” digit as that of “hour” digit. After finishing clock setting, touch and hold “On/off” icon for 3 seconds to keep the setting.

CX 7712 L

- Connect the power cord with an power socket.
- Slide or press the motor speed regulator button and light switch to turn vent hood on or off as shown in the following picture.

Push button type



-  = OFF button
-  = Low speed button
-  = Medium speed button
-  = High speed button
-  = Lamp button

Notes:

Adjust the motor speed of the vent hood according to the thickness of smoke / steam generated by the cooking process.

CAUTION:

- Avoid direct contact between the vent hood and open flames from the stove.
- To obtain optimum filtering result, turn off the vent hood 20 – 30 minutes after having finished cooking.



Part 5: Maintenance

MODENA exhaust hood specifically designed for a long term use so that it does not require complicated maintenance. However, there are some things that are recommended to take care of your exhaust hood so that the quality is maintained. Turn the unit off and unplug the power cord from the electrical source before cleaning

Cleaning the Cabinet:

To clean the surface of exhaust hood cabinet from sticky oil particles, use a cloth / sponge and soap water and then dry it out. The cabinet should be cleaned after each cooking session.

Cleaning the Filter:

Smoke / steam from cooking and oil particles generated by the cooking process will immediately be absorbed by the filter and therefore the filter should be cleaned regularly

1. Aluminum Filter:

- For routine usage, clean the aluminum filter once every 10 – 15 days by soaking the filter in a container filled with soap water for 1 hour (look at image) and use a soft brush to scrub it and then dry the filter thoroughly before placing it back to its proper position.
- Aluminum filter can be cleaned using a dishwasher.
- Avoid bending the filter when you wash it.

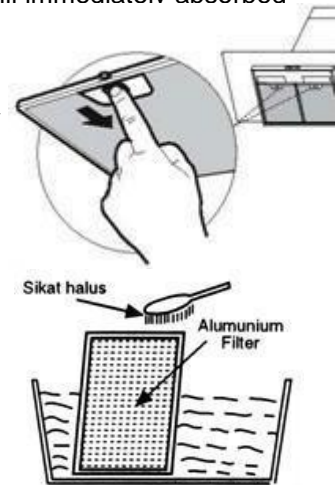

2. Carbon Filter :

Carbon filter must be replaced with a new one at least once every 4 months or when the carbon filter is no longer capable to absorb the cooking odor.

- Remove the aluminum filter first.
- Remove the carbon filter by pulling the hook (for square-shaped filter) or rotating it (for round – shaped filter).
- Install the new carbon filter.
- Reinstall the aluminum filter.

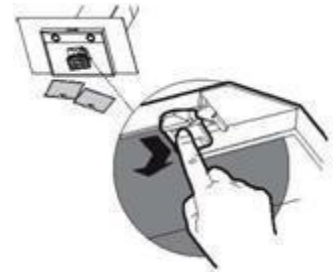

ATTENTION:

Carbon filter cannot be washed and must be replaced with a new one in accordance with the description above

Cleaning oil container:

Clean the oil cup when cleaning aluminum filter together, or if the cup already filled a half of cup.

- Remove the oil cup by slide to left or right as the slot.
- Wash using soap water, rinse and drying.
- Re-install the oil up on the exact position.

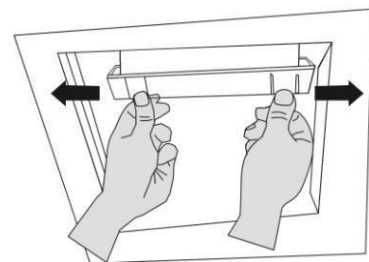

Changing the Light Bulb :

1. Turn off the Hood and unplug the power cord.
2. Disconnect the wire and remove the lamp from exhaust hood body.
3. Change the bulb with the same size and power type.
4. Install the new lamp on the exhaust hood body and reconnect the wire



Part 6: Problem and Solution

Do check the things below before contacting our Service Center, if there is any interference with your exhaust hood:

PROBLEM	POSSIBLE CAUSE	RECOMMENDED ACTION
Exhaust hood is not working	<ul style="list-style-type: none"> - Power cord is not yet connected to the electrical socket. - Electrical socket does not have any electricity 	<ul style="list-style-type: none"> - Connect the power cord to the electrical socket. - Connect the power cord to a properly functioning electrical socket
Deteriorating of Suction Power	<ul style="list-style-type: none"> - Dirty aluminum filter - Dirty carbon filter 	<ul style="list-style-type: none"> - Clean the aluminum filter, dry it and place it back on the exhaust hood. - Replace the carbon filter with a new one.
Motor fan is not functioning	<ul style="list-style-type: none"> - Motor coil is broken 	<ul style="list-style-type: none"> - Contact MODENA Call Center
Motor stops working after a while	<ul style="list-style-type: none"> - Safety thermal regulator is active 	<ul style="list-style-type: none"> - The vent hood is installed too close to the stove. - Air circulation is not optimal. - Contact MODENA Service Center.

Part 7: Precaution

- Make sure the hood is turned on after a while to allow the air around the cooking area to circulate properly and make sure the hood is turned off after this process..
- Periodically inspect the filter and oil reservoir. Make sure that the filter is in clean and good condition and make sure the oil reservoir is not exceeding the specified limit.
- If you smell burnt / burnt smell from the hood, immediately turn off the hood and contact the MODENA Service Center.
- Perform a routine service on your stove every 3 (three) months, because if there are problems / problems with your exhaust hood, it can be immediately identified and repaired. Contact MODENA Service Center

Part 8: Specification

MODEL	CX 9753	CX 9330	CX 9150
Type	Chimney - Wall	Chimney - Wall	Chimney - Wall
Cabinet Material	Stainless + tempered glass	Stainless + tempered glass	Stainless
Front Panel Color	Diamond black	Stainless	Stainless
Motor	1 Turbo	1 Turbo	1 Turbo
Lamp	2 LED	2 LED	2 LED
Fan Speed	3	3	3
Ionizer (Germinator)	Ya	Ya	Ya
Fitler Type	Cassette Aluminum + Carbon Filter + Vit.C	Cassette Aluminum + Carbon Filter + Vit.C	Cassette Aluminum+ Carbon + Vit.C
Control Panel	Tombol Sentuh	Tombol Tekan	Tombol Tekan
Voltage (V)	220 – 240V / 50Hz	220 – 240V / 50Hz	220 – 240V / 50Hz
Motor Power	190 W	190 W	190 W
Lamp Power	2 x 2 W	2 x 2.5 W	2 x 2 W
Air Flow (m3/h)	1000	900	900
Dimention (P x L x T) mm	895 x 400 x (770 – 1150)	900 x 500 x (580 -1060)	900 x 500 x (580 -1060)

MODEL	CX 7310 L	CX 7110 L	CX 9301
Type	Wall	Chimney - Wall	Chimney - Wall
Cabinet Material	Metal + tempered glass	Stainless + tempered glass	Stainless
Cabinet Color	Black	Black	Stainless
Front Panel Color	Black	Black	Black
Motor	1 Turbo	1 Turbo	1 Turbo
Lamp	LED	LED	LED
Fan Speed	3	3	3
Ionizer (Germinator)	No	No	Yes
Fitler Type	Cassette Aluminum + Carbon Filter	Cassette Aluminum + Carbon Filter	Cassette Aluminum + Carbon
Control Panel	Push Button	Push Button	Push Button
Voltage (V)	220 – 240V / 50Hz	220 – 240V / 50Hz	220 – 240V / 50Hz
Motor Power	100 W	100 W	210 W
Lamp Power	2 x 2 W	2 x 2.5 W	2 x 2 W
Air Flow (m3/h)	1000	900	900
Dimention (P x L x T) mm	700 x 500 x (560 – 1040)	700 x 450 x (670 – 1050)	895 x 500 x (570 – 1050)

MODEL	CX 9701 L	CX 9356
Type	Wall	Chimney - Wall
Cabinet Material	Metal + tempered glass	Stainless + tempered glass
Cabinet Color	Black	Stainless
Front Panel Color	Black	Black
Motor	1 Turbo	1 Turbo
Lamp	LED	LED Stripe
Fan Speed	3	4
Ionizer (Germinator)	No	No
Filter Type	Cassette Aluminum + Carbon Filter	Cassette Aluminum + Carbon Filter + Vit. C filter
Control Panel	Push Button	Touch Control
Voltage (V)	220 – 240V / 50Hz	220 – 240V / 50Hz
Motor Power	170 W	300 W
Lamp Power	2 x 2 W	1 x 8 W
Air Flow (m3/h)	1000	1000
Dimension (P x L x T) mm	900 x 340 x (800 – 1180)	895 x 500 x (570 – 1050)

MODEL	CX 9777	CX 9177	CX 9157
Type	Wall	Chimney - Wall	Chimney - Wall
Cabinet Material	Stainless Steel + tempered glass	Stainless Steel + tempered glass	Stainless Steel + tempered glass
Cabinet Color	Stainless	Stainless	Stainless
Front Panel Color	Black	Black	Black
Motor	DC Motor	DC Motor	DC Motor
Lamp	LED	LED	LED
Fan Speed	3	3	3
Ionizer (Germinator)	No	No	No
Filter Type	Stainless steel Mesh Filter	Stainless steel Mesh	Stainless steel Mesh
Control Panel	Touch Control + Gesture Control	Touch Control + Sliding Touch Control	Touch Control + Gesture Control
Voltage (V)	220 – 240V / 50Hz	220 – 240V / 50Hz	220 – 240V / 50Hz
Motor Power	268 W	1230 W	200 W
Lamp Power	2 x 2 W	1 x 4 W	1 x 4 W
Air Flow (m3/h)	1600	900	900
Dimension (P x L x T) mm	895 x 425 x (660 – 1150)	700 x 500 x (560 – 1020)	895 x 500 x (570 – 1050)

MODEL	CX 7712 L	CX 9156	CX 9106
Type	Chimney	Wall	Wall
Cabinet Material	Metal	Stainless Steel + tempered glass	Stainless Steel + tempered glass
Cabinet Color	Black	Stainless	Stainless
Front Panel Color	Black	Black	Black
Motor	1 Turbo	1 Turbo	1 Turbo
Lamp	2 LED	2 LED	LED
Fan Speed	3	3	3
Ionizer (Germinator)	No	No	No
Filter Type	Cassette Aluminum + Carbon Filter	Cassette Aluminum + Carbon Filter	Cassette Aluminum + Carbon
Control Panel	Push Button	Push Button	Push Button
Germinator / Ionizer	No	Yes	No
Voltage (V)	220 – 240V / 50Hz	220 – 240V / 50Hz	220 – 240V / 50Hz
Motor Power	160 W	210 W	210 W
Lamp Power	2 x 1.5 W	2 x 2 W	2 x 2 W
Dimension (P x L x T) mm	695 x 325 x (680 – 1070)	910 x 505 x (550 – 1030)	310 x 505 x (550 – 1030)

MODEL	CX 6301	CX 6330	C 6150
Type	Wall	Chimney - Wall	Chimney - Wall
Cabinet Material	Stainless Steel + Tempered Glass	Stainless Steel + Tempered Glass	Stainless Steel
Cabinet Color	Stainless	Stainless	Stainless
Front Panel Color	Black	Stainless	Stainless
Motor	1 Turbo	1 Turbo	1 Turbo
Lamp	LED	2 LED	2 LED
Control Panel	Push Button	Push Button	Push Button
Fan Speed	3	3	3
Filter Type	Cassette Aluminum Filter + Carbon Filter + Filter Vit.C	Cassette Aluminum Filter + Carbon Filter + Filter Vit.C	Cassette Aluminum Filter + Carbon Filter + Filter Vit.C
Germinator / Ionizer	Yes	Yes	Yes
Motor Power	210 W	190 W	190 W
Lamp Power	2 x 2 Watt	2 x 2.5 Watt	2 x 2 Watt
Dimension (P x L x T) mm	600 x 505x(570-1050)	600 x 500 x (580-1060)	600 x 500 x (580-1040)

Specifications of this appliance may change without notice to improve the quality of the product

Images in this manual are schematic and may not match the exact product. Values stated on the machine labels or in the documentation within are obtained in laboratory in accordance to the relevant standards. Depends on the unit's operational and environmental condition.

