

# User Manual Book Wall Chimney Hood

## **Piazza Series**

CX 9150, CX 6150  
CX 7110 L

## **Forli Series**

CX 9753, CX 9701 L, CX 9777  
CX 9754, CX 7754

## **Modica Series**

CX 7712 L

## **Imola**

CX 9313 L, CX 7310 L  
CX 9313 S, CX 7313 S

## **Ferrara Series**

CX 9301, CX 6301

## **Diva Series**

CX 9330, CX 6330

## **Faenza Series**

CX 9356

## **Cessena**

CX 9177, CX 9157, CX 9156

# TABLE OF CONTENTS

|  |    |
|--|----|
| Part 1: Safety Warnings                                | 3  |
| Electrical Shock Hazards                               | 3  |
| Part 2: Name of Parts                                  | 4  |
| Part 3: Installation                                   | 6  |
| Preparations of Installation                           | 6  |
| Installing the Hood on Wall                            | 7  |
| Creating Holes on the Wall and Installing the Brackets | 8  |
| Installing the Hood Body                               | 9  |
| Working Method   | 10 |
| Installation (Ducting System)                          | 11 |
| Installation (Recirculating System)                    | 12 |
| Chimney Installation                                   | 13 |
| CX 9157, CX 9177, and CX 9777 Installation Height      | 15 |
| Part 4: How to Use                                     | 17 |
| Push Button Type                                       | 17 |
| Electronic Button + Display Type                       | 18 |
| Touch Button Type                                      | 18 |
| Clock Setting  | 18 |
| Touch Control  | 20 |
| LCD Display  | 21 |
| Operating Instructions                                 | 22 |
| CX 9777  | 22 |
| CX 9157 / CX 9177                                      | 23 |
| CX 9754 / CX 7754                                      | 23 |
| Part 5: Maintenance                                    | 24 |
| Cleaning the Cabiner                                   | 24 |
| Cleaning the Filter                                    | 24 |
| Cleaning oil Container                                 | 25 |
| Changing the Light Bulb                                | 25 |
| Part 6: Problem & Solution                             | 26 |
| Part 7: Precaution                                     | 27 |
| Part 8: Specification                                  | 28 |

This guide book explains everything you need to know about your new product. Please contact our Customer Care should you need further assistance through [www.modena.com](http://www.modena.com)

## PART 1: SAFETY WARNINGS

- Do not allow children to operate the unit.
- This exhaust hood is designed for home use only, not suitable for the environmental condition, bake shop, barbecue, and other commercial purposes.
- The exhaust hood should be cleaned periodically so that its power is maintained.
- Clean the exhaust hood according to the instructions contained in this book and keeps it away from the danger of being burnt.
- No direct grilling on a gas stove.
- Keep your kitchen remains good circulation.
- Before connecting the unit to a power source, make sure the power cord is in good shape. If there is damage to the power cord, the replacement must be performed by qualified personnel or contact the MODENA Service Center for replacement process.
- The room should have good ventilation during the use of exhaust hood on gas stoves or other fuels.
- The exhaust hood waste pipe should be separated with an air-duct.
- Regulations regarding the air exhaust must be met.
- The unit is not intended to be used by persons (including children) with a physical, sensory, or mental disability, or lack of experience and knowledge unless they have been given supervision or instructions concerning the use of the appliance by the person who is responsible for their safety.
- Children should be supervised to ensure that they are not playing with the unit.
- Do not strike a fire under the sucker of the exhaust hood.
- The exhaust hood is not aimed to be installed on top of the stove that had more than four burners.

### Electrical Shock Hazards

- Connect the unit only to a grounded power socket correctly. If you are in doubt, ask advice from an experienced technician who is suitably qualified.
- The failure to follow these instructions may cause electric shock, fire, or other hazards that are fatal.

## PART 2: NAME OF PARTS

CX 9313 S, CX 9313 L, CX 7313 S, CX 7313 L, CX 9330, CX 6330, CX 9301, CX 6301

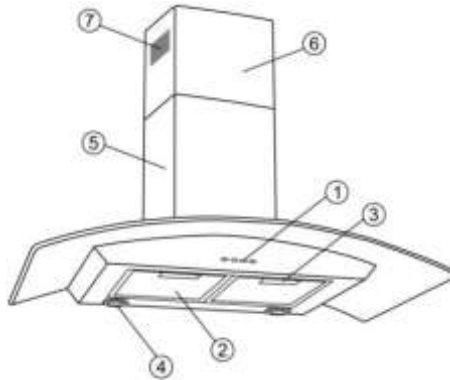

1. Control Panel
2. Cassette Aluminum Filter
3. Cassette Aluminum Filter Handle
4. Lamp
5. Main Chimney
6. Upper Connector Chimney
7. Circulation Hole

CX 9150, CX 6150, CX 7110 L, CX 9156

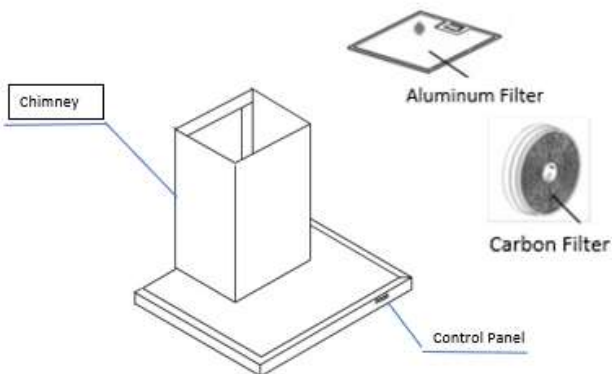

## CX 9753

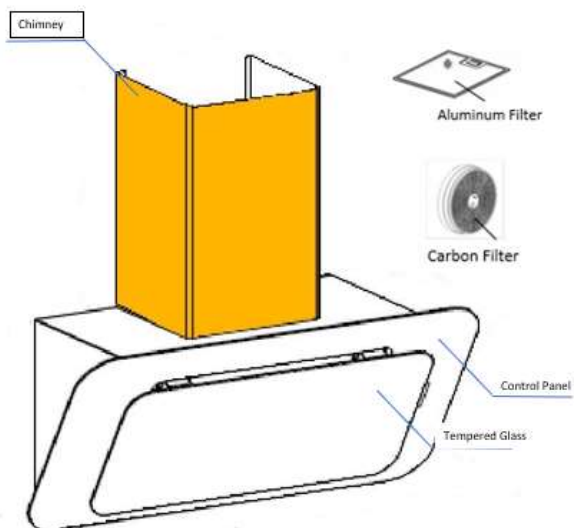

## CX 9356

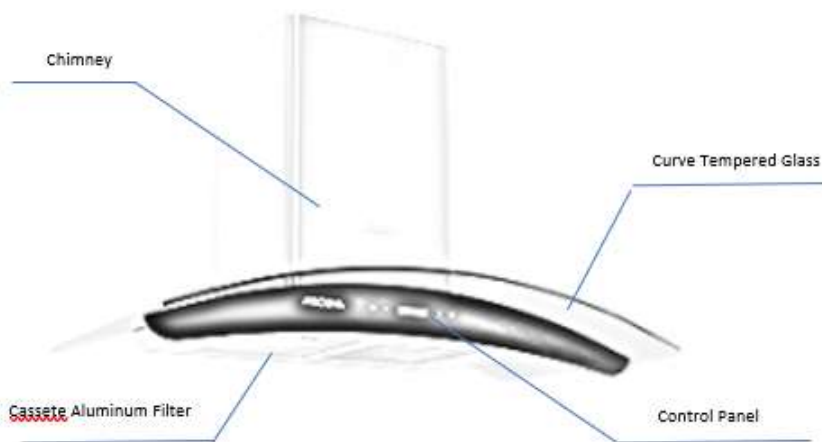

## CX 9701 L

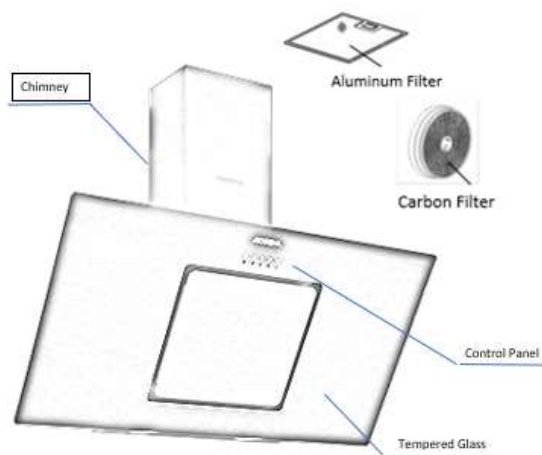

## CX 7712

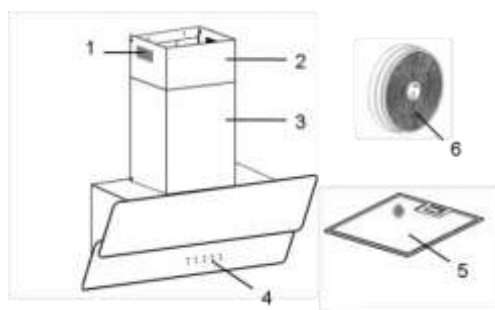

1. Circulation Hole
2. Upper Chimney
3. Main Chimney
4. Control Panel
5. Aluminum Filter
6. Carbon filter

## CX 9777

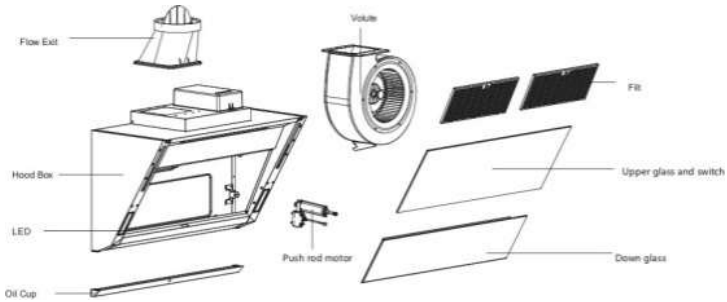

- The image is a general overview and is not necessarily the same as the product you receive.
- Features and other attributes are depending on the type of products

## CX 9157/ CX 9177

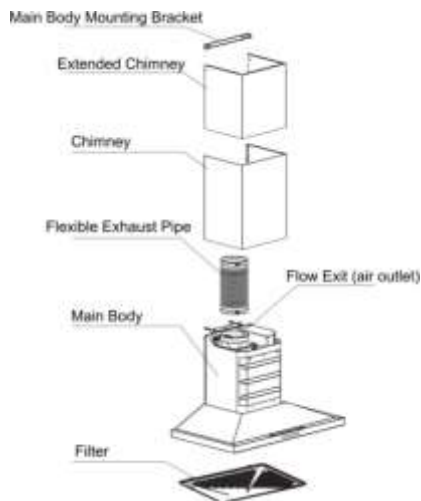

## CX 9754 & CX 7754

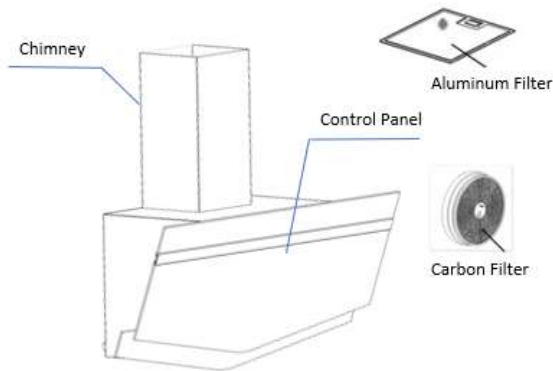

- The image is a general overview and is not necessarily the same as the product you receive.
- Features and other attributes are depending on the type of products

## PART 3: INSTALLATION

### Preparations of installation:

The exhaust hood is equipment which vacuums the smoke and odor produced in cooking process. With an exhaust hood, your kitchen will be free from oil particles which produces bad odor.

- If you have a waste pipe outside, the exhaust hood can be connected using extraction duct (enamel, aluminum, flexible pipe or a fire-resistant material with an inner diameter of 150 mm), see the following picture:
- Before installation, switch off the unit and unplug the power cord from the power socket

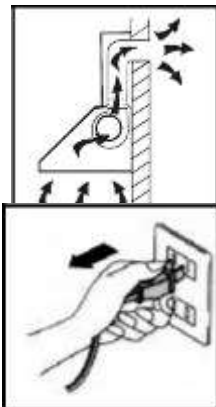



- Check the strength of wall on which the hood is to be installed. Make sure the wall can sustain the weight / load of the hood.
- The hood should be installed precisely over the stove at a vertical distance of 65 - 75 cm from the stove surface.

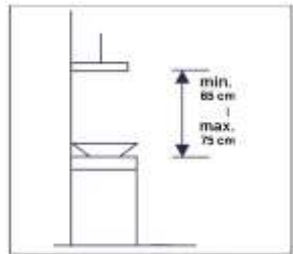

### Installing the Hood on Wall

The hood must be installed in an upright position to prevent the oil from flowing to one side and dripping out of the exhaust hood.

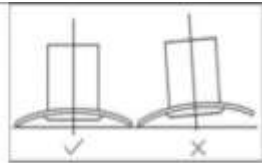

## Creating Holes on the Wall and Methods for Installing Bracket

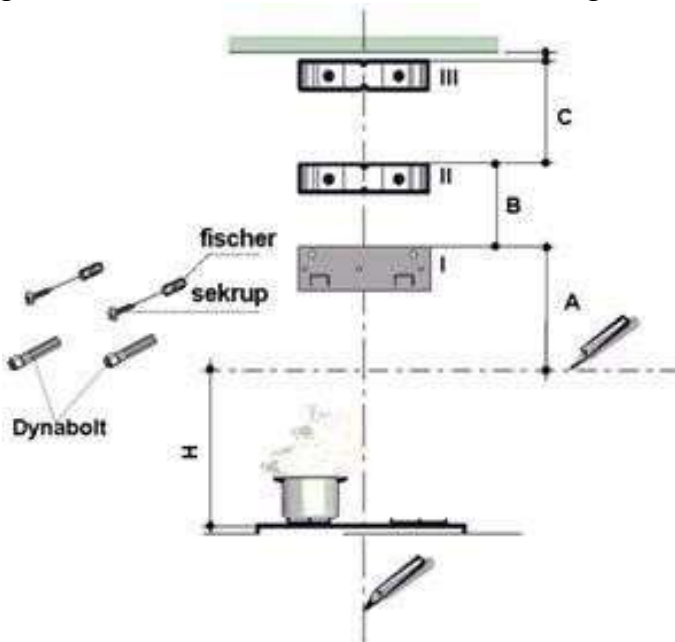

| Model     | A (cm) | B (cm) | C (cm) |
|-----------|--------|--------|--------|
| CX 9753   | 37.5   | 39     | 39     |
| CX 9330   | 34.5   | 20.5   | 49     |
| CX 6330   | 34.5   | 20.5   | 49     |
| CX 9150   | 34.5   | 20.5   | 49     |
| CX 6150   | 34.5   | 20.5   | 49     |
| CX 7712 L | 25     | 39     | 39     |

## NOTES

- Height / distance are 65 – 75 cm, except for CX 9753 type where the height / distance is 35 – 40 cm.
- For CX 7712 L, the height H is 34 – 45 cm
- For CX 9754 / CX 7754 the height is 34 – 45 cm
- For CX 9753, we recommend installation for use with a stove without the top cover.
- Height / Distance C can be shortened in accordance to the ceiling height.
- Make a vertical line on the wall to its highest point or to an appropriate height on the center part of the area where the vent hood is to be installed
- Make a horizontal line at H (cm) distance from the stove to mark the lowest limit for the hood.
- Install bracket I on the wall just like on the picture above up to height A and mark the holes for expansion bolt and plastic wall anchor. Especially for CX 9753, attach the unit on the wall up to height A and mark the holes for expansion bolt/plastic wall anchor/screw.
- Install bracket II on the wall just like on the picture above up to height B and mark the holes for plastic wall anchor hole.
- Install bracket III on the wall just like on the picture above up to height C and mark the holes for plastic wall anchor hole.
- Drill the wall with a  $\varnothing$  10 mm for expansion bolt and  $\varnothing$  8 mm for plastic wall anchor in all marked sections.
- Insert the expansion bolt and plastic wall anchor into the hole.
- Install all brackets using nut for expansion bolt and screw for the available plastic wall anchor

## Installing the Hood Body

- Install hood's body on the bracket I on the wall or on the screw head especially for CX 9753.
- Connect the exhaust system with the spigot / flange if the exhaust hood will be operated in a ducting / exhaust system.

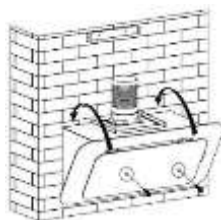

- Install the main chimney and the upper chimney on brackets I and II with the screws that already provided.



## Working Method

MODENA exhaust hood has 2 principle of work:

### Ducting system:

In this mode, the hood operates by sucking the smoke / odor in the cooking process and then releasing it out of the vent through the exhaust system.

To connect the hood with the duct system, use "spigot/flange" which is designed with a diameter of 150 mm.

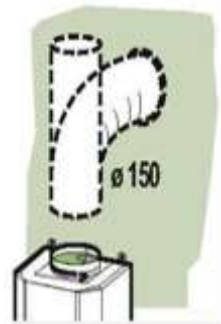

Several things which require attention in installing the ducting system exhaust hood:

1. Carbon filter must be removed. Only use the aluminum filter.
2. If the hood is installed in a multi-storied building or an apartment, consult with the person in charge of the building / apartment prior to installing the exhaust system.
3. Hood with ducting system should be used in an open-air room with good air circulation.

### Recirculating System

In this version, the vent hood sucks the smoke / cooking odor and filters it through an aluminum filter and carbon filter. The filtered smoke is then reticulated into the room. This system is used if the premise renders it impossible to install a ducting system

Several things which must be ensured when installing a vent hood with reticulating system:

1. Both carbon filter and aluminum filter must be used.
2. The position of both filters must be precise.
3. Circulation holes on the exhaust hood are not allowed to be closed

## Installation (Ducting System)

Observe the warning in the instruction sheet concerning the operation of the appliance when air is discharged from the room

When the range hood and appliance supplied with energy other than electricity are simultaneously in operation, the negative pressure in the room must be not exceed 4 Pa ( $4 \times 10^{-5}$  Bar)

- Drill 3 x 8mm holes to accommodate the bracket. Screw and tighten the bracket onto the wall with the screws & screw plugs provided

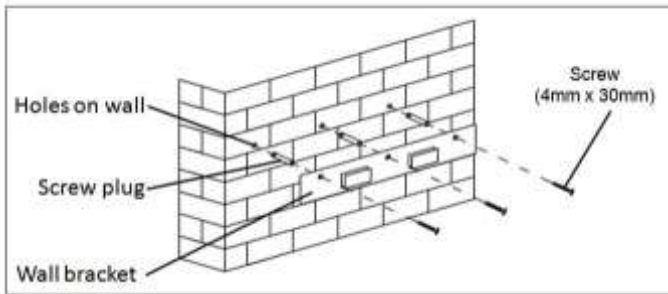

- For inclined panel Model, need to drill 4 x 8mm extra holes & fixing screws & screw plugs before installation.

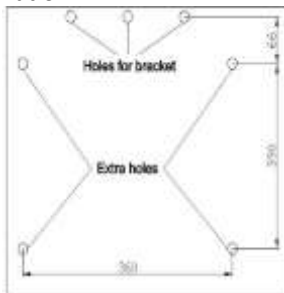

- Leave up the exhaust hood and hang onto the wall bracket hook.

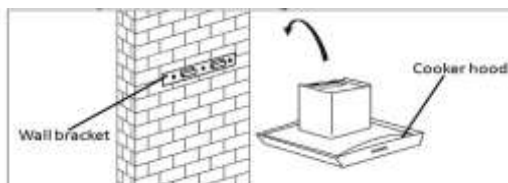

- Fix the one-way-valve to the air outlet of the exhaust hood. Then, attached the exhaust pipe into the one-way-valve as shown below.

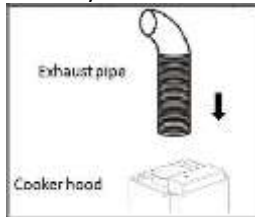

### Installation (Re-circulating System):

- If you do not have an outlet to the outside, exhaust pipe is not required and the installation is similar to the one show in section “Installation (Ducting/Exhaust System)”.

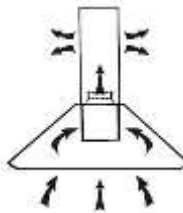

- Activated carbon filter can be used to trap odors.
- In order to install the activated carbon filter, the grease filter should be detached first by press the lock and pull it downward.

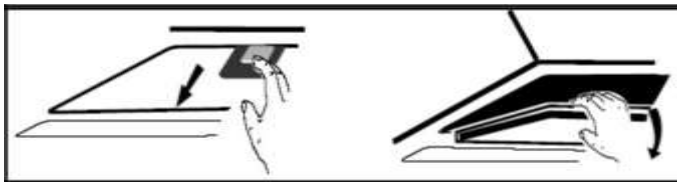

- Plug the activated carbon filter into the unit and turn it in clockwise direction. Repeat the same on the other side



## NOTE

- Make sure the filter is securely locked. Otherwise, it would loosen and cause dangerous.
- When activated carbon filter attached, the suction power will be lower.
- Carbon filters are installed at the rear of the grill and had to be replaced after three months.

## Chimney installation

### For Glass model and T shape model

- By put the upper chimney into lower chimney. Then pulling out the upper chimney upwards. Adjust to reach the height required.

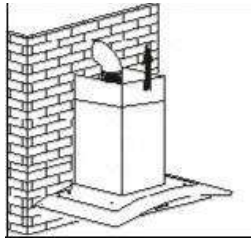

- Sliding the chimney to adjust the chimney height. When the height you required is reached, then hang the fixing hole to the fixing screws as showed in below pictures

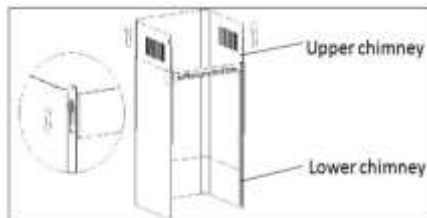

- Drill 2 × 8 mm holes to accommodate the plate II. Screw and tighten the plate II into the wall with two screws provided. Assemble the chimney into the unit and fix it with two screws

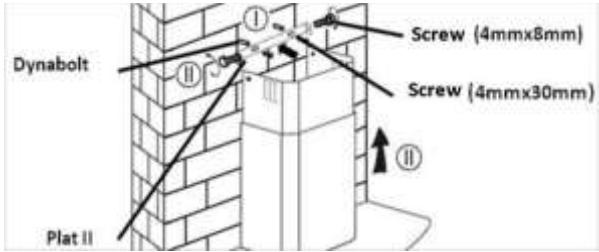

For Tower Model

- Put the inner chimney into upper chimney .Then pulling out the upper chimney upwards. Adjust to reach the height required



- Fix the lower chimney with two pieces of 4x8 mm screws

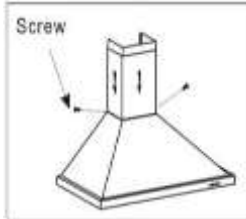



- Sliding the chimney to adjust the chimney height. When the height you required is reached, then fix two pieces of 4x8 mm screws onto the hole fixing with plate I as showed in below pictures

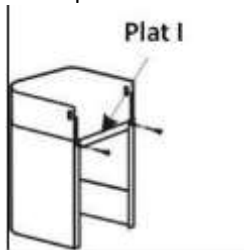

- Drill 2 x 8 mm holes to accommodate the plate II. Screw and tighten the plate II into the wall with two screws provided.

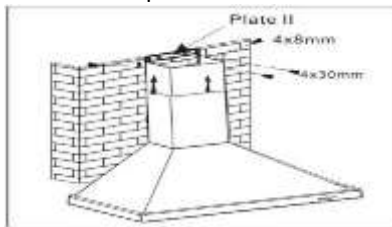

- Assembly the chimney into the unit and fix it with two screws.

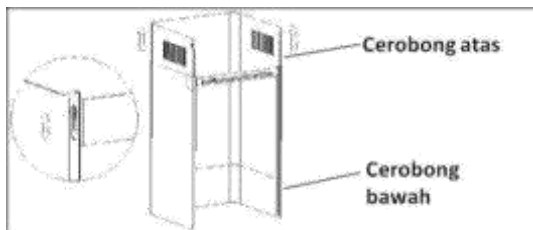

- For optimal air extraction :
- Keep exhaust duct short and straight.
- Do not reduce the size or restrict the exhaust duct.
- Minimize bends.
- Make sure the helix of the flexible exhaust duct is tightly drawn rather than slacking.
- Determine height between cooker hob and base of hood.
- Mark wall to suit all bracket locations. Drill holes of 50 mm depth at the selected drilling position.

- Insert the expansion tubes to fix the bracket onto the wall.
- Install the flow exit to the hood and follow by connecting the flexible exhaust duct to the flow exit.
- Strengthened the connection between the flow exit and the flexible exhaust duct with screws.
- Lift and hang the hood to the wall bracket and please ensure it sits firmly on the bracket.
- Direct the other end of the flexible exhaust duct to the outlet or wall.
- Fit in the safety baffle of the hood onto the wall to strengthen the position and to reduce vibration when the hood is switched on.
- Chimney extension can be installed to the ceiling or wall.
- Ensure the oil collection container is in place before the hood is being used. To remove it for cleaning, slide the oil collection container from front to rear, vice versa for inserting it into position
- Ensure there is proper ventilation in the cooking area.
- Instructions concerning the discharge of air have to be followed.
- Does not use flame under the range hood.
- Avoid using materials which could cause spurts of flame near the range hood.
- Never touch the lamp when it is on.
- Do not dismantle, repair or modify the range hood on your own.

## PART 4: HOW TO USE

### NOTES:

Adjust the motor speed of the exhaust hood according to the thickness of smoke / steam generated in the cooking process.

### Push Button



**OFF / 0** To switch off the Hood



Activate Motor at Low Speed



Activate Motor at Medium Speed



Activate Motor at High Speed



To Turn On/Off the Light

### Electronic Button + Display

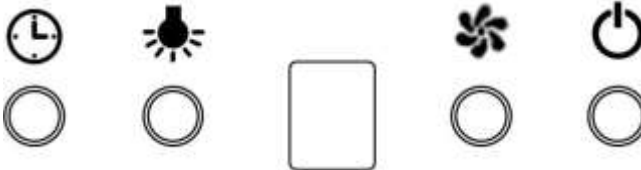

To Turn On/Off the Hood



To Adjust the Motor's Speed (Low Medium-High)



To Activate the Shut-off Timer (After 9 Minutes motor will switch off automatically)



To Turn On/Off the Light

## Touch Button

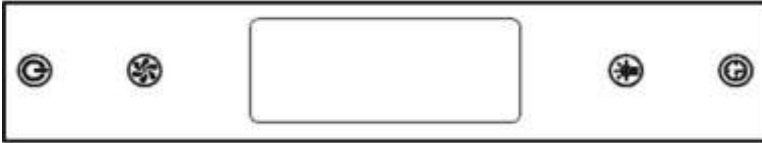

To Set the Usage Time



To Turn On/Off the Light



To Adjust the Speed Level (Low-Medium-High)









To Turn On/Off the Hood

If the button is pressed, the unit will work in which the motor speed depending on the last setting

## Clock Setting

The default setting for the time when it was first turned on is 12:00 PM. If the power is not connected or cut off, the unit will return to the initial setting is 12:00 and you have to reset.



To set the clock can be done when the motor and lights are not in working condition. The way to setting the clock as follow:

1. Touch the button  around 2 until 5 seconds, the display will show, the first two digits will blink indicates for setting of the hours. Then adjust with touch the  button to increase or the touch  to decrease. The largest value for hour is 23 and will not working if it is exceeded 23 and function  will not working if it has reached the lower limit of 00. The addition value by every touch is 01.
2. Touch the  button once more for 2 until 5 seconds, the display will show **88:88** the last two digits will blink which indicates to set the minute. Then adjust it by touching the button to increase or the button to decrease. The largest value for minute is 59 and will not working when it is exceeded 59 and function  will not working if it reached the lower limit of 00. The addition value by every touch is 01.

3. Press the  button one more time to finish the Clock's Setting

### Setting the Timer

The Timer can be set when the motor or lamp is on. Timer duration is set in three periods: 5 minutes/ 15 minutes / 30 minutes/ Cancel.



1. To set the timer, touch the button  once for 5 minutes, twice for 15 minutes, thrice for 30minutes, four times to cancel, five times for 5 minutes and so on. After the timer's time is finish, the motor and lamp will turn off automatically.
2. To change an ongoing timer, touch the  for 5 seconds or until the correct time is displayed.

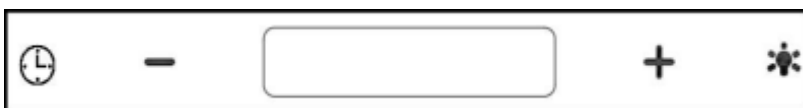



### Touch control





After plug in power, it will automatically sets in standby mode

 Timer's Button

Times setting keep pressing it while in standby mode to enter time setting, hour display will flash, press  or  to set the time.

Press  to change into minute setting, press  or  to set the time, press  again or wait 10s to finish the time setting.

Timer setting, short press during working mode, pre-set cycle:  
off→15mins→30mins→45mins→off:  
off→15menit→30menit→45menit→off.

Press  or  to adjust the time unless when the timer setting is "off"

 Speed increase button

 Speed decrease button

 Light button

## LCD Display

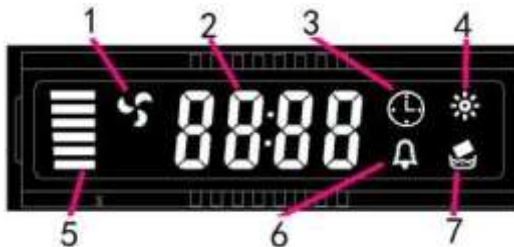

1. Fan symbol will be active when the fan is working
2. Time display
3. Timer
4. Light
5. Fan speed
6. Alarm symbol
7. Active buzzer carbon replacement symbol

## Operating Instructions

- Confirm that when the hood is installed, plug in the power cord, and the hood sends out a “drip” sound, indicating that the power is connected.
- Please use the following methods for the first time. If there is any discrepancy, please contact the local distributor or service department as soon as possible

## CX 9777



- To start the hood, press the wake button first and then touch the ring with clockwise touch. The wind is changed from small to large, when the whole ring is red when it starts to suck, it keeps running for 3 minutes, and then

automatically switches to strong gear, and the ring of the ring turns off a section, if it is to be reopened again to the whole circle.

- All the display lights up for 1 second and then goes out. The buzzer sends out a “bite” prompt, and the whole machine enters the shutdown state.
- Gesture control: When the machine is shut down, the palm swings from left to right or from right to left once, and the hood starts. The fan runs in strong gear and the lighting is turned on at the same time.
- Power key: for switch/delay operation. When shutdown operation is invalid, press this key to shut down or enter a delay of 3 minutes.
- Weak gear key: Used to set the weak gear of air volume. When the power is on, press this key shortly to switch the air flow gear between weak gear and close cycle.
- Super suction key: Used to set the air volume of super suction gear. The super-strong suction time is 3 minutes, after 3 minutes, it will automatically turn into strong-gear operation state.
- Lighting keys: used to turn on or off lights
- Cleaning Lock Screen Function: Press the Lighting keys for 3 seconds to enter the cleaning lock screen state, and press 3 seconds to exit the cleaning lock screen.
- The indicator light of “strong key” keeps flickering; the hood enters the state of cleaning lock screen. Press the “strong key” for 3 seconds to exit the lock screen. The buzzer whistles and the panel close.
- Clock display: In the state of clock display, press the power key for a long time. Start flickering in the hourly area, press the “weak” or “strong” button
- Adjust the clock. After setting the hour, press the “power” button, switch to the minute area and start flickering. Adjust the minute and press again.
- After 3 seconds, save the clock settings.

## CX 9157/ CX 9177



- Gesture control: When the hood is off, use your hand to wave from right to left above the icon once; the hood will start to work immediately. At the same time, the light will be turned on. When the hood is working, use your hand to wave

from left to right above the icon once, the hood will stop working immediately. At the same time, the light will be turned off.

- Illumination: Touch the icon to turn on the light and touch one more time to turn off the light. Boost: Touch this icon once and the hood will start to work in the state of boost for 3 minutes and then change to work at high speed. If you want to make the hood work at boost state again, touch the icon one more time.
- Time/display: In the state of time/display, touch and hold the icon “On/off”, “hour” area will start to flash, and you can touch “Boost” or “High speed” to adjust the “hour” digit. After the “hour” digit is set, touch the “On/off” icon, then “minute” area will start to flash and you can adjust the “minute” digit as that of “hour” digit. After finishing clock setting, touch and hold “On/off” icon for 3 seconds to keep the setting.

#### CX 9754 & CX 7754

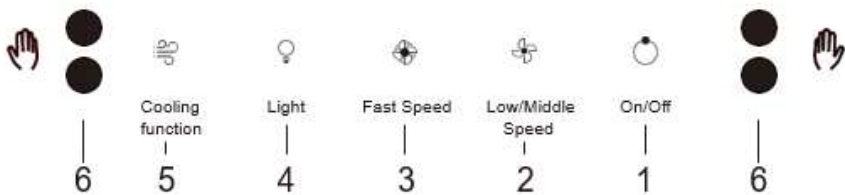



1. On / off key:When this key is touched in the off state,entering the standby state and waiting for other key operations;When you touch this key again, it returns to the off state.Time-delay function:when the motor is running,touch this key to enter a 1-minute time-delay shutdown state,the indicator light flashes during the delay.In the off state,long press this key for 2 seconds to turn off the somatosensory function;long press again for 2 seconds to turn on the somatosensory function.
2. Low/Middle speed key:Press this botton when in the standby state, then the button will light up while the fan will enter the slow running state. Press the button once again, the fan enters a medium-speed running state. Press the button repeatedly to stop the fan and return to the standy state.
3. Fast speed key:Touch this key in standby state, the key lights up,and the fan enters the fast running state.Touch the key again to return to the standby



state, and the fan stops running.

4. Light key: In any state, touch this key to turn on the light. When you touch this key again, the light will turn off. (The lamp is controlled independently, it can be turned off by manual shutdown)
5. Cooling function key: In any state, touch this key to turn on the Cooling function.
6. Gesture motion sensor: Wave your hand from left to right to turn on the cooker hood. The cooker hood will start to operate with high fan speed and LED light will turn on. Wave your hand from right to left to turn off the cooker hood. The cooker hood will stop operate and turn off immediately.  
(Tips: When using a somatosensory switch, please align your palm with the left and right sensing area! The ideally gesture motion speed from left to right or right to left shall within two seconds! The ideally distance of gesture motion from control panel is from 5 - 10CM!)

Heat Cleaning Function

1. Press and hold the  button for 2 seconds to activate the heat cleaning function
2. The cooker hood will operate the heat cleaning function for 15 minutes
3. The indicator light will keep blinking.
4. Press and hold the  button until deactivate the heat cleaning function or press  button to deactivate this function.

## PART 5: MAINTENANCE

MODENA exhaust hood specifically designed for a long term use so that it does not require complicated maintenance. However, there are some things that are recommended to take care of your exhaust hood so that the quality is maintained. Turn the unit off and unplug the power cord from the electrical source before cleaning

## Cleaning the Cabinet

To clean the surface of exhaust hood cabinet from sticky oil particles, use a cloth / sponge and soap water and then dry it out. The cabinet should be cleaned after each cooking session.

## Cleaning the Filter

Smoke / steam from cooking and oil particles generated by the cooking process will immediately be absorbed by the filter and therefore the filter should be cleaned regularly

### 1. Aluminum Filter:

- For routine usage, clean the aluminum filter once every 10 – 15 days by soaking the filter in a container filled with soap water for 1 hour (look at image) and use a soft brush to scrub it and then dry the filter thoroughly before placing it back to its proper position.
- Aluminum filter can be cleaned using a dishwasher.
- Avoid bending the filter when you wash it.

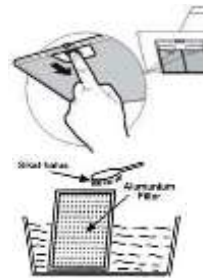

### 2. Carbon Filter :

Carbon filter must be replaced with a new one at least once every 4 months or when the carbon filter is no longer capable to absorb the cooking odor.

- Remove the aluminum filter first.
- Remove the carbon filter by pulling the hook (for square-shaped filter) or rotating it (for round – shaped filter).
- Install the new carbon filter.
- Reinstall the aluminum filter.

### ATTENTION

Carbon filter cannot be washed and must be replaced with a new one in accordance with the description above

## Cleaning oil container

Clean the oil cup when cleaning aluminum filter together, or if the cup already filled a half of cup.

- Remove the oil cup by slide to left or right as the slot.
- Wash using soap water, rinse and drying.
- Re-install the oil up on the exact position.

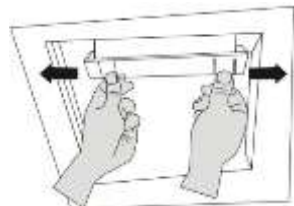

### Changing the Light Bulb

1. Turn off the Hood and unplug the power cord.
2. Disconnect the wire and remove the lamp from exhaust hood body.
3. Change the bulb with the same size and power type.
4. Install the new lamp on the exhaust hood body and reconnect the wire

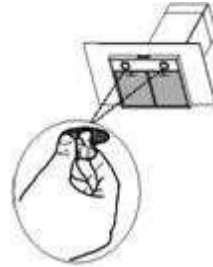

## PART 6: TROUBLESHOOTING

Do check the things below before contacting our Service Center, if there is any interference with your exhaust hood:

| Problem                           | Possible Cause   | Recommended Action  |
|-----------------------------------|--|---|
| Exhaust hood is not working       | <ul style="list-style-type: none"> <li>• Power cord is not yet connected to the electrical socket.</li> <li>• Electrical socket does not have any electricity</li> </ul> | <ul style="list-style-type: none"> <li>• Connect the power cord to the electrical socket.</li> <li>• Connect the power cord to a properly functioning electrical socket</li> </ul>          |
| Deteriorating of Suction Power    | <ul style="list-style-type: none"> <li>• Dirty aluminum filter</li> <li>• Dirty carbon filter</li> </ul>   | <ul style="list-style-type: none"> <li>• Clean the aluminum filter, dry it and place it back on the exhaust hood.</li> <li>• Replace the carbon filter with a new one.</li> </ul>           |
| Motor fan is not functioning      | <ul style="list-style-type: none"> <li>• Motor coil is broken</li> </ul>   | <ul style="list-style-type: none"> <li>• Contact MODENA Call Center</li> </ul>  |
| Motor stops working after a while | <ul style="list-style-type: none"> <li>• Safety thermal regulator is active</li> </ul>   | <ul style="list-style-type: none"> <li>• The vent hood is installed too close to the stove.</li> <li>• Air circulation is not optimal.</li> <li>• Contact MODENA Service Center.</li> </ul> |

## PART 7: PRECAUTION

- Make sure the hood is turned on after a while to allow the air around the cooking area to circulate properly and make sure the hood is turned off after this process.
- Periodically inspect the filter and oil reservoir. Make sure that the filter is in clean and good condition and make sure the oil reservoir is not exceeding the specified limit.
- If you smell burnt / burnt smell from the hood, immediately turn off the hood and contact the MODENA Service Center.
- Perform a routine service on your stove every 3 (three) months, because if there are problems / problems with your exhaust hood, it can be immediately identified and repaired. Contact MODENA Service Center

## PART 8: SPECIFICATION

| MODEL                    | CX 9753                                   | CX 9330                                   | CX 6330                                   |
|--------------------------|---|---|---|
| Cabinet's Material       | Stainless + tempered glass                | Stainless + tempered glass                | Stainless + tempered glass                |
| Front panel's color      | Diamond black                             | Stainless                                 | Stainless                                 |
| Number of Motor(s)       | 1 Turbo                                   | 1 Turbo                                   | 1 Turbo                                   |
| Lamp(s)                  | 2 LED                                     | 2 LED                                     | 2 LED                                     |
| Exhaust speeds           | 3   | 3   | 3   |
| Ionizer (Germinator)     | Y   | Yes                                       | Yes                                       |
| Filter's type            | Cassette Aluminum + Carbon Filter + Vit.C | Cassette Aluminum + Carbon Filter + Vit.C | Cassette Aluminum + Carbon Filter + Vit.C |
| Control                  | Touch Control                             | Push Button                               | Push Button                               |
| Voltage                  | 220 – 240V / 50Hz                         | 220 – 240V / 50Hz                         | 220 – 240V / 50Hz                         |
| Motor Power              | 190 W                                     | 190 W                                     | 190 W                                     |
| Lamp Power               | 2 x 2 W                                   | 2 x 2.5 W                                 | 2 x 2.5 W                                 |
| Air circulation (m3/jam) | 1000                                      | 900                                       | 900                                       |
| Dimension (P x L x T) mm | 895 x 470 x (770 – 1150)                  | 900 x 500 x (580 -1060)                   | 600 x 500 x (580 -1060)                   |

| MODEL                    | CX 9150                           | CX 6150                           | CX 7110 L                                |
|--------------------------|-----------------------------------|-----------------------------------|--|
| Cabinet's Material       | Stainless                         | Stainless                         | Metal                                    |
| Front panel's color      | Stainless                         | Stainless                         | Black                                    |
| Number of Motor(s)       | 1 Turbo                           | 1 Turbo                           | 1 Turbo                                  |
| Lamps                    | 2 LED                             | 2 LED                             | 2 LED                                    |
| Exhaust speeds           | 3                                 | 3                                 | 3  |
| Ionizer (Germinator)     | Yes                               | Yes                               | No                                       |
| Filter's type            | Cassette Aluminum+ Carbon + Vit.C | Cassette Aluminum+ Carbon + Vit.C | Cassette Aluminum Filter + Carbon Filter |
| Control                  | Push Button                       | Push Button                       | Push Button                              |
| Voltage                  | 220 – 240V / 50Hz                 | 220 – 240V / 50Hz                 | 220 – 240V / 50Hz                        |
| Motor Power              | 190 W                             | 190 W                             | 100 W                                    |
| Lamp Power               | 2 x 2 W                           | 2 x 2 W                           | 2 x 2 W                                  |
| Air circulation (m3/jam) | 900                               | 900                               | 700                                      |
| Dimension (P x L x T) mm | 900 x 500 x (550 - 1040)          | 600 x 500 x (580 - 1060)          | 700 x 450 x (540–1020)                   |

| MODEL                    | CX 7310 L                                | CX 9301   | CX 9301   |
|--------------------------|--|---|---|
| Cabinet's Material       | Metal + Tempered glass                   | Stainless +Tempered glass                                 | Stainless +Tempered glass                                 |
| Cabinet's Color          | Black                                    | Stainless   | Stainless   |
| Front panel's color      | Black                                    | Black   | Black   |
| Number of Motor(s)       | 1 Turbo                                  | 1 Turbo   | 1 Turbo   |
| Lamps                    | LED                                      | LED   | LED   |
| Control                  | Push Button                              | Push Button   | Push Button   |
| Exhaust speeds           | 3  | 3   | 3   |
| Filter's type            | Cassette Aluminum Filter + Carbon Filter | Cassette aluminum filter, Carbon filter, Vit. + C filter. | Cassette aluminum filter, Carbon filter, Vit. + C filter. |
| Ionizer (Germinator)     | No                                       | Yes   | Yes   |
| Motor Power              | 100 Watt                                 | 210 Watt  | 210 Watt  |
| Lamp Power               | 2 x 2 Watt                               | 2 x 2 Watt  | 2 x 2 Watt  |
| Voltage                  | 220 – 240 V ; 50/60Hz                    | 220 – 240 V ; 50/60Hz                                     | 220 – 240 V ; 50/60Hz                                     |
| Dimension (P x L x T) mm | 700 x 500 x (560–1045)                   | 900 x 500 x ( 570 – 1050 )                                | 600 x 500 x ( 570 – 1050 )                                |

| MODEL                    | CX 9777                          | CX 9177                          | CX 9157                          |
|--------------------------|----------------------------------|----------------------------------|----------------------------------|
| Cabinet's Material       | Stainless Steel + Tempered Glass | Stainless Steel + Tempered Glass | Stainless Steel + Tempered Glass |
| Cabinet's Color          | Stainless                        | Stainless                        | Stainless                        |
| Front panel's color      | Black                            | Black                            | Black                            |
| Motor's Type             | DC Motor                         | DC Motor                         | DC Motor                         |
| Lamps                    | LED                              | LED                              | LED                              |
| Control                  | Touch Control + Gesture Control  | Touch Control + Gesture Control  | Touch Control + Gesture Control  |
| Exhaust speeds           | Stepless Speed                   | Stepless Speed                   | 3                                |
| Filter's type            | Stainless Mesh Filter            | Stainless Steel                  | Stainless Steel                  |
| Ionizer (Germinator)     | No                               | No                               | No                               |
| Motor Power              | 268 Watt                         | 230 Watt                         | 200 Watt                         |
| Lamp Power               | 2 x 2 Watt                       | 1x 4 Watt                        | 1 x 4 Watt                       |
| Voltage                  | 220V – 50Hz                      | 220V – 50Hz                      | 220V – 50Hz                      |
| Dimension (P x L x T) mm | 895 x 425 x 660                  | 895 x 515 x 655                  | 895 x 520 x 600                  |

| MODEL                | CX 7712 L   | CX 9156   | CX 9356   |
|----------------------|---|---|---|
| Cabinet's Material   | Metal Painted + Tempered Glass                          | Stainless Steel + Tempered Glass                        | Stainless Steel + Tempered Glass                        |
| Cabinet's Color      | Stainless   | Stainless   | Stainless   |
| Front panel's color  | Black   | Stainless   | Black   |
| Number of Motor(s)   | 1 Turbo   | 1 Turbo   | 1 Turbo   |
| Lamps                | LED   | 2 LED   | LED Stripe  |
| Control              | Push Button   | Push Button   | Touch Control   |
| Exhaust speeds       | 3   | 3   | 4   |
| Filter's type        | Cassette Aluminum Filter + Carbon Filter + Filter Vit.C | Cassette Aluminum Filter + Carbon Filter + Filter Vit.C | Cassette Aluminum Filter + Carbon Filter + Filter Vit.C |
| Ionizer (Germinator) | Yes   | Yes   | Yes   |
| Motor Power          | 210 W   | 190 W   | 300   |
| Lamp Power           | 2 x 2 Watt  | 2 x 2.5 Watt  | 1 Z 8 Watt  |
| Voltage              | 695x325x( 680-1070 )                                    | 895x 600 x ( 650-1250 )                                 | 900x 500 x ( 570-1050 )                                 |

| MODEL                    | CX 9701 L                                | CX 9754                                  | CX 7754                                 |
|--------------------------|--|--|---|
| Cabinet's Material       | Metal +Tempered glass                    | Metal +Tempered glass                    | Metal +Tempered glass                   |
| Cabinet's Color          | Black                                    | Black                                    | Black                                   |
| Front panel's color      | Black                                    | Black                                    | Black                                   |
| Number of Motor(s)       | 1 Turbo                                  | 1  | 1                                       |
| Lamps                    | LED                                      | LED                                      | LED                                     |
| Control                  | Push Button                              | Touch Control + Gesture Control          | Touch Control + Gesture Control         |
| Exhaust speeds           | 3  | 3  | 3                                       |
| Filter's type            | Cassette Aluminum Filter + Carbon Filter | Cassette Aluminum Filter + Carbon Filter | Cassette aluminum filter, Carbon filter |
| Ionizer (Germinator)     | No                                       | No                                       | No                                      |
| Motor Power              | 170 Watt                                 | 210 Watt                                 | 210 Watt                                |
| Lamp Power               | 2 x 2 Watt                               | 1 X 1.5 Watt                             | 1 X 1.5 Watt                            |
| Voltage                  | 220 – 240 V ; 50/60Hz                    | 220 – 240 V ; 50/60Hz                    | 220 – 240 V ; 50/60Hz                   |
| Dimension (P x L x T) mm | 900 x 340 x (800–1180)                   | 900 x 360 x (740–1080)                   | 700 x 360 x (740–1080)                  |

| MODEL                    | CX 7313 S                                     | CX 9313 S                                     | CX 9313 L                                     |
|--------------------------|---|---|---|
| Cabinet's Material       | Stainless Steel + Tempered Glass              | Stainless Steel + Tempered Glass              | Metal Painted + Tempered Glass                |
| Cabinet's Color          | Stainless                                     | Stainless                                     | Black   |
| Front panel's color      | Stainless                                     | Stainless                                     | Black   |
| Number of Motor(s)       | 1   | 1   | 1   |
| Lamps                    | LED   | LED   | LED   |
| Control                  | Push Button                                   | Push Button                                   | Push Button                                   |
| Exhaust speeds           | 3   | 3   | 3   |
| Filter's type            | Cassette Aluminum Filter + Carbon Filter Matt | Cassette Aluminum Filter + Carbon Filter Matt | Cassette Aluminum Filter + Carbon Filter Matt |
| Ionizer (Germinator)     | No  | No  | No  |
| Motor Power              | 220 Watt                                      | 220 Watt                                      | 220 Watt                                      |
| Lamp Power               | 2 X 2 Watt                                    | 2 X 2 Watt                                    | 2 X 2 Watt                                    |
| Voltage                  | 220 – 240 V ; 50/60Hz                         | 220 – 240 V ; 50/60Hz                         | 220 – 240 V ; 50/60Hz                         |
| Dimension (P x L x T) mm | 700 x 500 x 565                               | 900 x 500 x 565                               | 900 x 500 x 565                               |

